

Z700A-A82

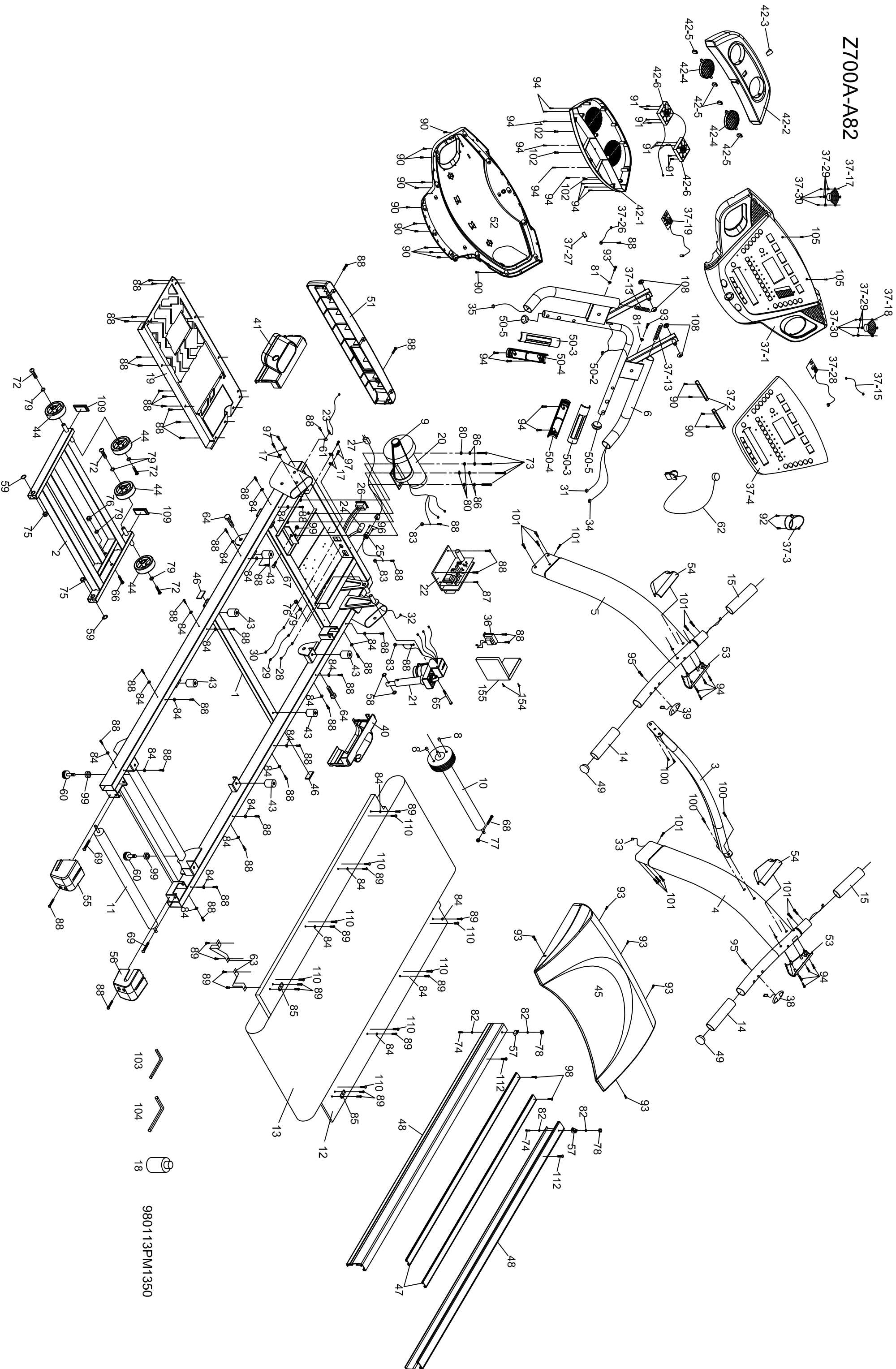

980113PM1350

SOLE - S77 Part List

PART#	Description	QTY
1	Main Frame	1
2	Incline Bracket	1
3	Handrail Support	1
4	Right Handrail	1
5	Left Handrail	1
6	Console Support	1
7	Deck Cross Brace	1
8	Ø10_Magnet	2
9	Drive Belt	1
10	Front Roller W/Pulley	1
11	Rear Roller	1
12	1375 × 614 × 25 m/m_Running Deck	1
13	510 × 3110 × 2.0T_Running Belt	1
14	Ø38 × 225m/m × 3T_Handgrip Foam (A)	2
15	Ø38 × 295 m/m × 3T_Handgrip Foam (B)	2
17	Wire Tie Mount	4
18	Lubricant	1
19	Frame Cover	1
20	Motor Bracket	1
21	Incline Motor	1
22	Controller	1
23	800m/m_Sensor W/Cable	1
24	Breaker	1
25	Power Socket	1
26	On/Off Switch	1
27	Power Cord	1
28	100m/m × 764 × 764_Connecting Wires (Black)	1
29	300m/m × 764 × 764_Connecting Wires (White)	1
30	300m/m × 764 × 764_Connecting Wires (Black)	1
31	800 m/m_Computer Cable (Upper)	1
32	800 m/m_Computer Cable (Lower)	1
33	1300 m/m_Computer Cable (Middle)	1
34	800 m/m_Speed Cable (Upper)	1
35	800 m/m_Incline Cable (Upper)	1
36	Adaptor	1
37	Console	1
37-1	Top Console Cover	1
37-2	Book Rack	2
37-3	Beverage Holder	1
37-4	Face Plate Lens Cover	1
37-13	Spring For Console	2
37-15	550m/m_Fan Computer Cable	1
37-17	70cm_Speaker W/Cable	1
37-18	25cm_Speaker W/Cable	1
37-19	Amplifier	1
37-26	400m/m_Console Ground Wire	1
37-28	Receiver, HR Assembly	1
37-29	Ø12×5.5T_Plastic Washer	6
37-30	3×6m/m_Sheet Metal Screw	6
38	300m/m_Speed Adjustment Switch W/Cable	1
39	300m/m_Incline Adjustment Switch W/Cable	1
40	Frame Base Cap (R)	1
41	Frame Base Cap (L)	1
42	Fan Assembly	1
42-1	Bottom Fan Cover	1
42-2	Top Fan Cover	1
42-3	Fan Power Switch	1
42-4	Deflector Fan Grill	2
42-5	Fan Grill Anchor	4
42-6	Fan	2
43	M8 × Ø30 × 35_Cushion	6
44	Ø81 × 35_Transportation Wheel	4
45	Top Motor Cover	1
46	□20×40_Square End Cap	2
47	1380 m/m_Inside Foot Rail	2
48L	1515 m/m_Outside Foot Rail	1
48R	1515 m/m_Outside Foot Rail	1
49	Ø38_Button Head End Cap	2
50	Handpulse Assembly	2
50-2	650m/m_Handpulse Wire, Coiled	1
50-3	Handpulse Assembly (Top)	2
50-4	Handpulse Assembly (Bottom)	2
50-5	Handpulse End Cap	2
51	Frame Front Cover	1
52	Bottom Console Cover	1
53	Right Handgrip Cap	2
54	Left Handgrip Cap	2
55	Rear Adjustment Base (L)	1
56	Rear Adjustment Base (R)	1
57	Motor Cover Anchor	2
58	Ø24 × Ø10 × 3T_Nylon Washer(A)	2
59	Ø50 × Ø13 × 3T_Nylon Washer(B)	2
60	Ø38 × 3/8" Adjustment Foot Pad	2
61	Sensor Rack	1
62	Safety Key	1
63	Belt Guide	2
64	1/2" × 1-1/2" Hex Head Bolt	2
65	3/8" × 4-1/2" Socket Head Cap Bolt (Alloy Steel)	1
66	3/8" × 3-3/4" Hex Head Bolt	1
67	3/8" × 1-3/4" Hex Head Bolt	1
68	M8 × 60m/m Hex Head Bolt	1
69	M8 × 80m/m Socket Head Cap Bolt	2
72	3/8" × 3/4" Button Head Socket Bolt	4
73	3/8" × 1-1/4" Hex Head Bolt	4
74	M5×30m/m Phillips Head Screw	2
75	1/2" Nyloc Nut	2
76	3/8" Nyloc Nut	2
77	M8 Nyloc Nut	1
78	M5_Nut	2
79	Ø19 × Ø10 × 1.5T_Flat Washer	6
80	Ø25 × Ø10 × 1.5T_Flat Washer	4
81	Ø5 × Ø15 × 1.0T_Flat Washer	2
82	Ø5 × Ø10 × 1.0T_Flat Washer	4
83	M5_Star Washer	3
84	Ø6.5 × 25 × 1.5T_Concave Washer	26
85	Ø6.5 × 25 × 50 × 1.5T_Concave Washer	2
86	Ø10 × 1.5T_Split Washer	4
87	5 × 19 m/m Tapping Screw	1
88	5 × 16 m/m Tapping Screw	45
89	4×12 m/m Sheet Metal Screw	14
90	3.5×12 m/m Sheet Metal Screw	16
91	3.5×32 m/m Sheet Metal Screw	8
92	3×10 m/m Sheet Metal Screw	2
93	5×16 m/m Tapping Screw	7
94	3×10 m/m Tapping Screw	21
95	4×38 m/m Sheet Metal Screw	2
96	3×10 m/m Sheet Metal Screw	2
97	3.5 × 12m/m Tapping Screw	4
98	4 × 25m/m Sheet Metal Screw	2
99	3/8" Nut	3
100	5/16" × 3/4" Button Head Socket Bolt	4
101	5/16" × 1/2" Button Head Socket Bolt	12
102	M3 × 18 m/m Phillips Head Screw	3
103	Combination M5 Allen Wrench & Phillips Head Screw Driver	1
104	M6 Allen Wrench	1
105	3 × 10 m/m Sheet Metal Screw	2
108	13m/m Bolt Cap	4
109	□25×50_Square End Cap	2
110	M8 × 35m/m Flat Head Countersink Bolt	8
112	5 × 45m/m Tapping Screw	2
154	3×8m/m Sheet Metal Screw	2
155	1.5T_Controller Back Plate	1
	Hardware Kit	1
	Overlay	1
	Decal, Console	1
	Decal, Frame Base	2
	Display, Upper	1