

SZ900-A922 TT8

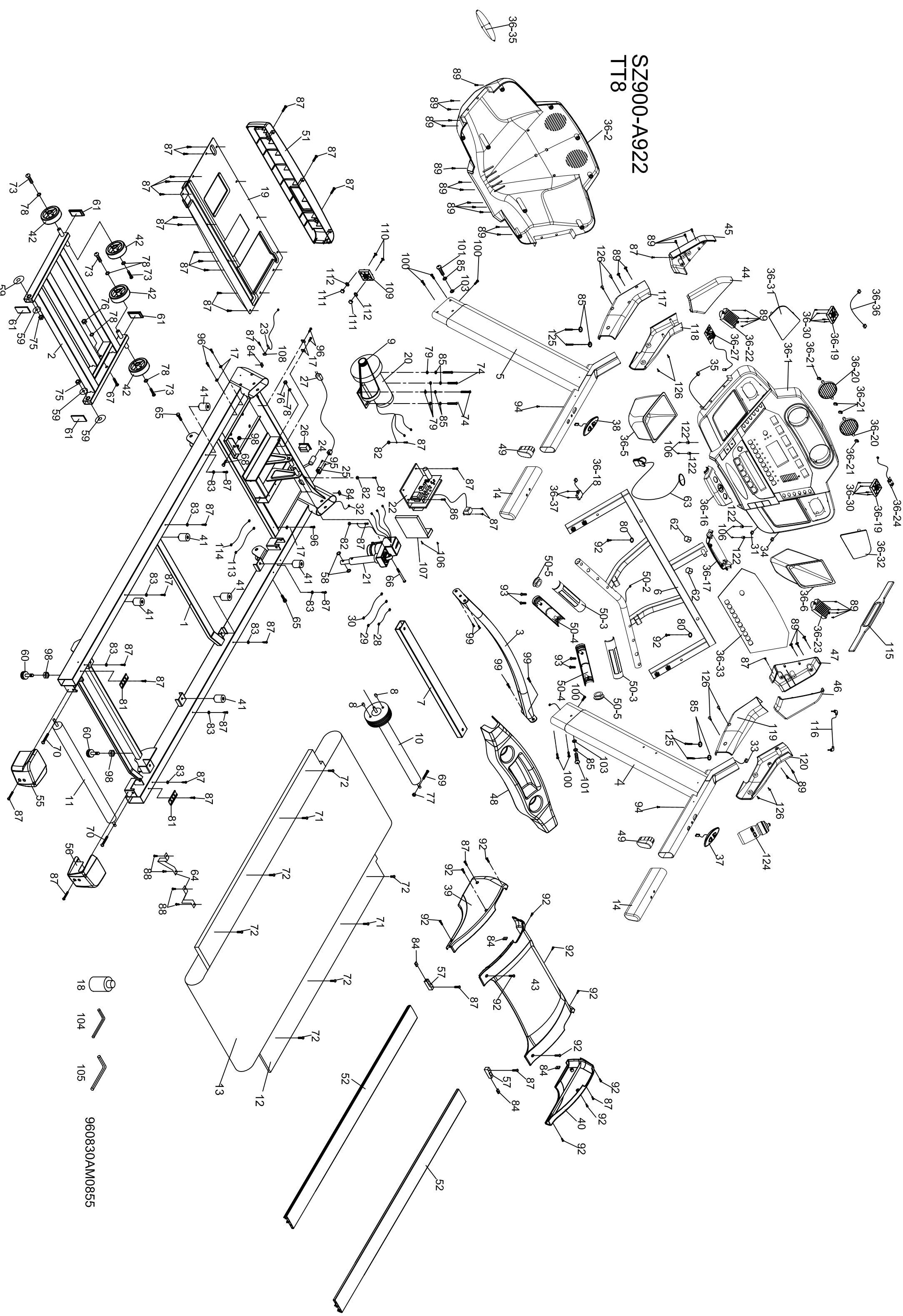

- 18
- 104
- 105

960830AM0855

VTT8 (588887) Part List

Parts #	Description	Qty
1	Main Frame	1
2	Incline Bracket	1
3	Handrail Support	1
4	Right Handrail Assembly	1
5	Left Handrail Assembly	1
6	Console Support	1
7	Deck Cross Brace	1
8	~10 Magnet (slug is sent with magnet)	2
9	Drive Belt (240J/610J)	1
10	Front Roller W/Pulley	1
11	Rear Roller	1
12	Running Deck (1410 x 680 x 25mm)	1
13	Running Belt (560 x 3250 x 2.5mm)	1
14	Handgrip Foam	2
17	Wire Tie Mount	5
18	Lubricant	1
19	Frame Cover	1
20	Motor, 3.5HP Turdan(blk/rd wires=600mm/ground wire=400mm)	1
21	Incline Motor	1
22	Controller	1
23	Sensor W/Cable	1
24	Breaker	1
25	Power Socket	1
26	On/Off Switch	1
27	Power Cord	1
28	100mm x 764 x 764 Connecting Wires (Black)	1
29	150mm x 764 x 764 Connecting Wires (White)	1
30	150mm x 764 x 764 Connecting Wires (Black)	1
31	800 mm Computer Cable (Upper)	1
32	550 mm Computer Cable (Lower)	1
33	1150 mm Computer Cable (Middle)	1
34	800 mm Speed Cable (Upper)	1
35	800 mm Incline Cable (Upper)	1
36	Console Assembly	1
36~1	Top Console Cover	1
36~2	Bottom Console Cover	1
36~5	Beverage Holder (L)	1
36~6	Beverage Holder (R)	1
36~16	Front Console Cover (Top)	1
36~17	Front Console Cover (Bottom)	1
36~18	300mm Safety Switch W/Moudule	1
36~19	Fan	2
36~20	Deflector Fan Grill	2

36~21	Fan Grill Anchor		4
36~22	700mm Speaker		1
36~23	250mm Speaker		1
36~24	Amplifier - speaker		1
36~27	Receiver, HR Assembly		1
36~30	3.5x32 m/m_Self Tapping Screw		8
36~31	Speaker Iron Net (L)		1
36~32	Speaker Iron Net (R)		1
36~33	Face Plate Lens Cover		1
36~35	Bottom Console Badge		1
36~36	Amplifier Power Cord		1
36~37	3x10 m/m_Self Tapping Screw		2
37	300mm Speed Adjustment Switch W/Cable		1
38	300mm Incline Adjustment Switch W/Cable		1
39	Motor Base Cap (L)		1
40	Motor Base Cap (R)		1
41	M8 x 30 x 35 Deck Cushion		6
42	Transportation Wheel (81 x 35)		4
43	Top Motor Cover		1
44	Left Connecting Cap (Top)	SET	1
45	Left Connecting Cap (Bottom)	SET	1
46	Right Connecting Cap (Top)	SET	1
47	Right Connecting Cap (Bottom)	SET	1
48	Beverage Holder		1
49	Ellipse End Cap		2
50	Handpulse W/Cable Assembly		2
50~2	Handpulse Wires		1
50~3	Handpulse Assembly Top		2
50~4	Handpulse Assembly Bottom		2
50~5	Handpulse End Cap		2
51	Front Motor Cover		1
52	1400mm Foot Rail		2
55	Rear Adjustment Base (L)		1
56	Rear Adjustment Base (R)		1
57	Motor Cover Anchor		2
58	ψ24 x ψ10 x 3T_Nylon Washer (A)		2
59	ψ50 x ψ13 x 3T_Nylon Washer (B)		4
60	Foot Pad		2
61	25 x 50_Square End Cap		4
62	13mm_Bolt Cap		2
63	800mm Ellipse Safety Key		1
64	70mm Belt Guide		2
65	1/2" x 57m/m_Hex Head Screw		2
66	3/8" x 4-1/2" _Socket Head Cap Screw		1
67	3/8" x 4" _Socket Head Cap Screw		1
68	3/8" x 1-3/4" _Hex Head Screw		1

69	M8 x 60m/m Hex Head Screw		1
70	M8 x 80m/m Socket Head Cap Screw		2
71	M8 x 55m/m Flat Head Countersink Screw		2
72	M8 x 35m/m Flat Head Countersink Screw		6
73	3/8" x 3/4" Button Head Socket Screw		4
74	3/8" x 1" Hex Head Screw		4
75	1/2" x 15T Nyloc Nut		2
76	3/8" x 7T Nyloc Nut		2
77	M8 x 8T Nyloc Nut		1
78	ψ19 x ψ10 x 1.5T Flat Washer		6
79	ψ25 x ψ10 x 1.5T Flat Washer		4
80	ψ5 x ψ15 x 1.0T Flat Washer		2
81	ψ6.5 x 25 x 1.0T x 2.5H Concave Washer		2
82	M5 Raised Washer		3
83	ψ6.5 x 25 x 1.5T x 5.8H Concave Washer		8
84	M5 Iron Plate Nut		6
85	3/8"x2.0T Split Washer		10
86	5 x19 m/m Tapping Screw		1
87	5 x16 m/m Tapping Screw		40
88	4x12 m/m Self Tapping Screw		4
89	3.5x12 m/m Self Tapping Screw		33
92	5x16 m/m Tapping Screw		13
93	3x10 m/m Tapping Screw		4
94	4x50 m/m Self Tapping Screw		2
95	3x10 m/m Self Tapping Screw		2
96	3.5 x16m/m Tapping Screw		5
98	3/8" Nut		3
99	5/16" x 3/4" Button Head Socket Screw		4
100	5/16" x 1/2" Button Head Socket Screw		6
101	3/8" x 2" Button Head Socket Screw		2
103	ψ10 Raised Washer		2
104	Combination M5 Allen Wrench & Phillips Head Screw Driver		1
105	M6 Allen Wrench		1
106	3×8mm Self Tapping Screw		6
107	1.5T Controller Back Plate		1
108	Sensor Rack		1
109	Controller Fan		1
110	M4x35 m/m Phillips Head Screw		2
111	M4 Nyloc Nut		2
112	ψ4 x ψ10 x 1.0T Flat Washer		2
113	250mm Motor Fan Connecting Cable(Black)		1
114	250mm Motor Fan Connecting Cable(Red)		1
115	Chest Strap		1
116	Audio Cable		1
117	Left Handgrip Side Cap (LL)		1
118	Left Handgrip Side Cap (LR)		1

119	Right Handgrip Side Cap (RL)		1
120	Right Handgrip Side Cap (RR)		1
122	ψ12×5.5T_Plastic Washer		4
124	Drink Bottle		1
125	3/8"×1-3/4" Button Head Socket Screw		4
126	M5×10mm_Phillips Head Screw		8
	Hardware Kit	003040	1
	Poly Sticker (Console)	003104	1
	Button Overlay		
	Upper Display Board	004118	1
	Lower Board	004117	1