

ST920-YT53-01  
SOLE LA

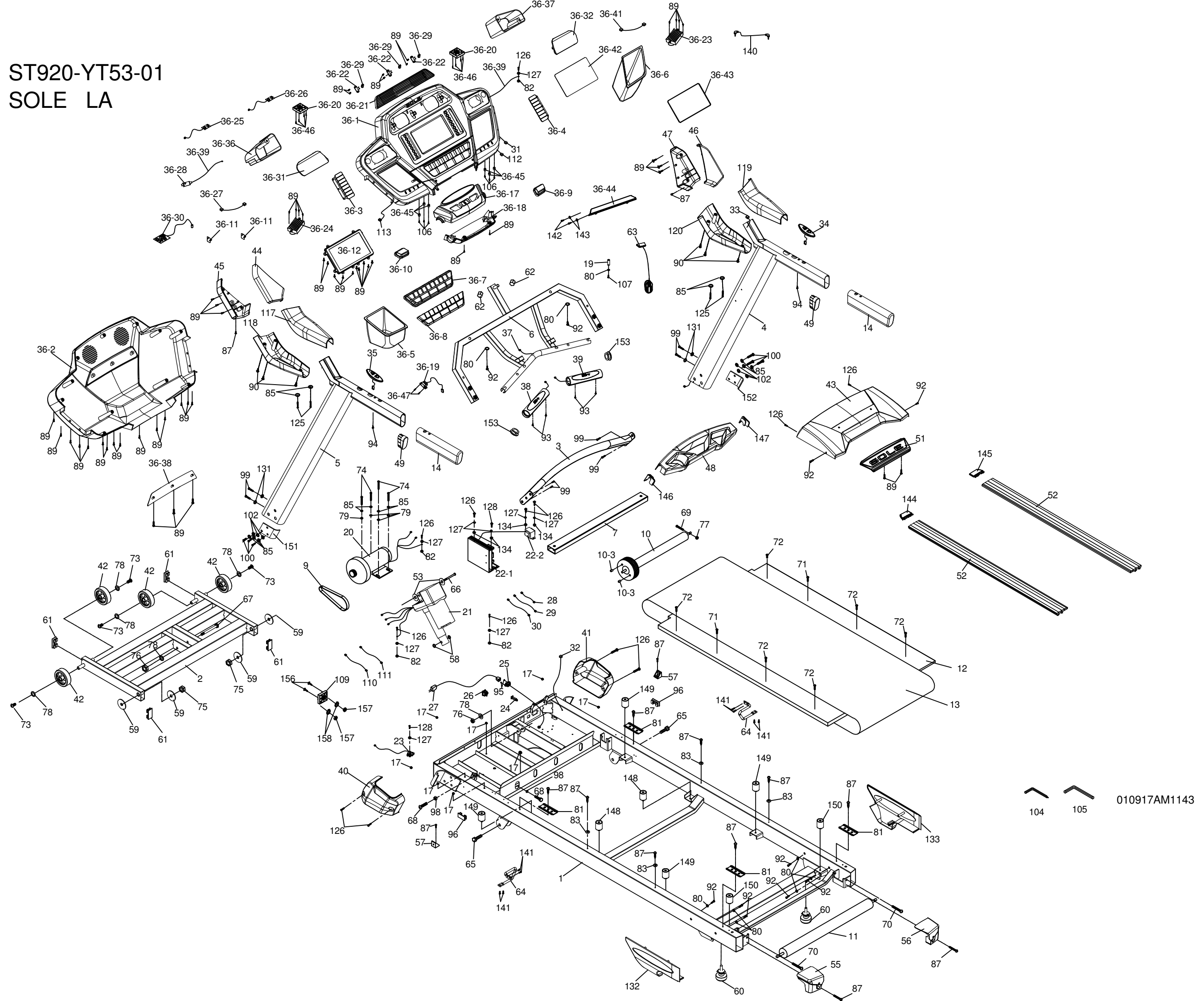

104 105 010917AM1143

# SOLE - TT8-588812 - PARTS LIST

Dyaco #	Material #	Detailed Descriptions	QTY
1	AA010109-Q2	Main Frame	1
2	AA030027-Q2	Incline Bracket	1
2	RAA030027-Q2	Incline Bracket assembly	1
3	AA060066-Q2	Handrail Support	1
4	AA040098-Q2	Right Upright	1
4	RAA040098-Q2	Right Upright assembly	1
5	AA040065-Q2	Left Upright	1
5	RAA040065-Q2	Left Upright assembly	1
6	AA050031-Q2	Console Support	1
7	TT440019-Q2	Deck Cross Brace	1
9	N010001	Drive Belt-(8J240)	1
10	K140040-Z9	W/Pulley-Ø75×647m/m	1
11	K140004-Z9	Rear Roller-Ø75×590m/m	1
12	H180004A-A1	Running Deck-(1410 × 680 × 25T)	1
13	H0743255-P5-Z2	Running Belt-(560 × 3255 × 2.5T)	1
14	L030014-A1	PVC Handgrip-(Ø36×76×3.0T×266m/m)	2
17	P060389	Clevis Pin Bracket	8
19	C077002-Z1	Safety Key Sleeve-(Ø10×Ø4.5×22m/m)	1
20	G020077B	Drive Motor-(YC783,3.0HP,90V,4200RPM,φ31,650m/m,Ground Wire250m/m,Label:4.0HP)	1
21	G110063	Incline Motor-(TM01-024,JS25A,N50198L,115V,1/6HP,350m/m,400m/m)	1
22-1	D020055	Motor Controller-(YJ-2350L,3.5HP)	1
22-2	D022028	Adaptor-(06144/115V(115V-12V/2A+12V/1A)EI-57)	1
23	F030191	1200m/m_Sensor W/Cable	1
24	F020001	Breaker-(A-0710W,250/125VAC,15A)	1
25	F010002	Power Socket-(SS-7B-VDER-4.8)	1
26	F030001	On/Off Switch-(RF1004-NBR4#W1AN,5mm,125/250VAC,16A,T85/55)	1
27	E060001	Power Cord	1
28	E010747	100m/m_Connecting Wire (Black)	1
29	E010756	350m/m_Connecting Wire (White)	1
30	E010757	350m/m_Connecting Wire (Black)	1
31	E020002	800m/m_Computer Cable (Upper/Lower)	1
32	E020016	550m/m_Computer Cable (Upper/Lower)	1
33	E020052	1200m/m_Computer Cable	1
34	N110007A	300m/m_Speed Adjustment Switch W/Cable	1
35	N110002A	300m/m_Incline Adjustment Switch W/Cable	1
36	RZ0YT53A-20	Console Assembly	1
36-1	P020338B-LZ-AT	Console Top Cover	1
36-2	P020343-A1	Console Bottom Cover	1
36-3	P170058-AC-BH	INCLINE Key(L)	1
36-4	P170058-AC-BJ	SPEED Key(R)	1
36-5	P220003-A1	Drink Bottle Holder (L)	1
36-6	P220004-A1	Drink Bottle Holder (R)	1
36-7	P170056-A1	Lower Controller Button-TPR	1
36-8	P170057-AC-BT	Button Frame	1
36-9	P170053-A9-BM	STOP Key-(185C)	1
36-10	P170052-A8-BL	START Key	1
36-11	B130062	Square Magnet Stop Plate-(20×14.8×7×0.3T)	2
36-12	D021141	Console Display Board-(P020250)	1

36-13	D021126	Key Board-(YJ-5962-K1)	1
36-14	D021128	START Key-(YJ-5962-K4)	1
36-15	D021129	STOP Key-(YJ-5962-K3)	1
36-16	D021127	Key Fast Board-(YJ-5962-K2)	2
36-17	P020342-JH	Front Console Cover (Top)	1
36-18	P020140-A1	Front Console Cover (Bottom)	1
36-19	F030200	300m/m_Safety Switch Module W/ Cable	1
36-20	F040101	Fan Assembly-(RDH8025Sx2+600mm+350mm+XHP-4)	1
36-21	P250003-A1	Deflector Fan Grill	1
36-22	P250004-A1	Fan Grill Anchor	3
36-23	F050003	550m/m_Speaker W/Cable(Optional)	1
36-24	F050004	200m/m_Speaker W/Cable(Optional)	1
36-25	D020533	300m/m_Sound Board W/Cable (Red)	1
36-26	D020534	500m/m_Sound Board W/Cable (White)	1
36-27	E030083	400m/m_HR monitor module W/Cable	1
36-28	F090108	(Salutron) HR monitor module(4600 I-pulse)	1
36-29	P060060-A1	Fan Grill Anchor	3
36-30	F110204	Amplifier Controller(Optional)	1
36-31	B130158-Z3	Speaker Iron Net (L)	1
36-32	B130159-Z3	Speaker Iron Net (R)	1
36-36	P020340-A1	Speaker Cover (L)	1
36-37	P020341-A1	Speaker Cover (R)	1
36-38	P020344-LZ	Console Bottom Cover	1
36-39	E040010	400m/m_Console Ground Wire	2
36-41	E060502	600m/m_Amplifier Cable(Optional)	1
36-42	P020256	LCD Transparent Piece-(115×202×2T)	1
36-43	P060424	9" Water-resist Rubber	1
36-44	P020339-AC	Book Rack-(A-BK)	1
36-45	P060183-A1	Speaker Grill Anchor-(Ø12×5.5T)	6
36-46	J396811	3.5 × 32m/m_Sheet Metal Screw(Optional)	8
36-47	J397003	3 × 10m/m_Sheet Metal Screw	2
37	E030094	150m/m_Handpulse Wire	1
38	F090242	400m/m_Handpulse W/Cable Assembly	1
39	F090243	400m/m_Handpulse W/Cable Assembly	1
40	P140037-A1	Frame Base Cover (L)	1
41	P140038-A1	Frame Base Cover (R)	1
42	P050004-A1	Transportation Wheel-(Ø82×Ø14×35m/m)	4
43	P010117-A1	Motor Top Cover	1
44	P070150-A1	Left Connecting Cap (Top)	1
45	P070151-A1	Left Connecting Cap (Bottom)	1
46	P070152-A1	Right Connecting Cap (Top)	1
47	P070153-A1	Right Connecting Cap (Bottom)	1
48	P220013-A1	Beverage Holder	1
49	P040019-A1	Handgrip End Cap-(Ø30×70)	2
51	P010116-LZ	Top Motor Cover Plate	1
52	M010009B-Z0	Foot Rail-(105×27.5×1350m/m)	2
53	P060410-A1	Ø10 × Ø25 × 0.8T_Nylon Washer	2
55	P030068B-A1	Rear Adjustment Base (L)	1
56	P030069B-A1	Rear Adjustment Base (R)	1
57	P060021-A1	Motor Cover Anchor(D)	2
58	P060221-A1	Ø24 × Ø10 × 3T_Nylon Washer (A)	2
59	P060206-A1	Ø50 × Ø13 × 3T_Nylon Washer (B)	4

60	P270012	Foot Pad-Ø50(3/8"-16UNC)	2
61	P040039-A1	25m/m × 50m/m_Square End Cap	4
62	P280010-A1	Bolt Cap-(Ø13mm)	2
63	N100029-A5	800m/m+300m/m_Trapezoidal Safety Key	1
64	C120300-ZL	Belt Guide-(Ø8×220m/m)	2
65	J031509Q	1/2" × 2-1/2" _Socket Head Cap Bolt	2
66	J031007U-Y9	3/8" × 1-3/4" _Socket Head Cap Bolt (Alloy Steel)	1
67	J031016G-Y9	3/8" × 4" _Socket Head Cap Bolt (Alloy Steel)	1
68	J011006-Y3	3/8" × 1-1/2" _Hex Head Bolt	2
69	J013012-Y3	M8 × 60m/m _Hex Head Bolt	1
70	J033016	M8 × 80m/m _Socket Head Cap Bolt	2
71	J043011R-Z4	M8 × 55m/m _Flat Head Countersink Bolt	2
72	J043007-Y3	M8 × 35m/m _Flat Head Countersink Bolt	6
73	J021002-Y3	3/8" × 3/4" _Button Head Socket Bolt	4
74	J011005-Y3	3/8" × 1-1/4" _Hex Head Bolt	4
75	J139112-Y3	1/2" × 15T _Nyloc Nut	2
76	J139011-Y3	3/8" × 7.0T _Nyloc Nut	2
77	J139261-Y3	M8 _Nyloc Nut	1
78	J210003-Y3	Ø19 × Ø10 × 1.5T _Flat Washer	6
79	J210008-Y3	Ø25 × Ø10 × 2.0T _Flat Washer	4
80	J210007-Z1	Ø3/16" × Ø15 × 1.0T _Flat Washer	9
81	B130013-Z1	Ø5.5 × 27 × 60 × 1T × 2.5H _Concave Washer	4
82	J270001-Z1	M5 _Star Washer	4
83	J570002-Z1	Ø6.5 × 25 × 1.5T × 5.8H _Main Frame	4
85	J260003-Y3	3/8" × 2.0T _Split Washer	14
87	J367105-Y3	5 × 16m/m _Tapping Screw	16
89	J396804-Y3	3.5 × 12m/m _Sheet Metal Screw	32
90	J396805-Y3	3.5 × 16m/m _Sheet Metal Screw	4
92	J377105-Y3	5 × 16m/m _Tapping Screw	10
93	J517003-Y3	3 × 10m/m _Tapping Screw	4
94	J526914-Y3	4 × 50m/m _Sheet Metal Screw	2
95	J547003-Z1	3 × 10m/m _Sheet Metal Screw	2
96	P040038-A1	20m/m × 40m/m_Square End Cap	2
98	J129021-Y3	3/8" _Nut	2
99	J340502-Y3	5/16" × 3/4" _Flat Head Socket Bolt	8
100	J021009S-Y3	3/8" × 2-1/4" _Button Head Socket Bolt(M6)	6
102	J210003-Y3	Ø10 × Ø19 × 1.5T _Flat Washer	6
104	J330001-Y3	Combination M5 Allen Wrench & Phillips Head Screw Driver	1
105	J330002-Y3	M6 _L Allen Wrench	1
106	J397002	3 × 8m/m _Sheet Metal Screw	6
107	J396813	3.5 × 40m/m _Sheet Metal Screw	1
109	F040011	Fan-(P1082HST,115V,50/60HZ,3.5/4.5W)	1
110	E010049	300m/m _Motor Fan Connecting Cable (Black)	1
111	E010050	300m/m _Motor Fan Connecting Cable (White)	1
112	E050058	800m/m _Speed Cable (Upper)	1
113	E050079	800m/m _Incline Cable (Upper)	1
117	P070142-A1	Left Handgrip Side Cap (Top)	1
118	P070143-A1	Left Handgrip Side Cap (Bottom)	1
119	P070144-A1	Right Handgrip Side Cap (Top)	1
120	P070145-A1	Right Handgrip Side Cap (Bottom)	1
121	J210028-Z1	Ø4 × Ø10 × 1.0T _Flat Washer	2
125	J021007-Y3	3/8" × 1-3/4" _Button Head Socket Bolt	4

126	J092001-Y3	M5 × 10m/m_Phillips Head Screw	13
127	J260008	M5_Split Washer	9
128	J092004	M5 × 20m/m_Phillips Head Screw	2
131	J220001-Y3	Ø8 × Ø23 × 1.5T_Curved Washer	4
132	P030072-A1	Logo Cover (L)	1
132	RP030072-A1	Logo Cover (L)+poly sticker	1
133	P030073-A1	Logo Cover (R)	1
133	RP030073-A1	Logo Cover (R)+poly sticker	1
134	J210006	Ø5 × Ø12 × 1.0T_Flat Washer	4
140	E090010	400m/m_Audio Cable	1
141	J367114-Y3	5 × 19m/m_Tapping Screw	8
142	J396801-Y3	3.5 × 6m/m_Sheet Metal Screw	2
144	P080044-A1	Foot Rail Cap (L)	1
145	P080045-A1	Foot Rail Cap (R)	1
146	P220028-A1	Beverage Holder Cover(L)	1
147	P220029-A1	Beverage Holder Cover(R)	1
148	P060406-AE	Cushion (Gray)-(M8×Ø30×37m/m)	2
149	P060407-A8	Cushion (Green)-(M8×Ø30×37m/m)	4
150	P060408-A1	Cushion (Black)-(M8×Ø30×37m/m)	2
151	B130048-Q2	Gusset (L) (150×24×90×4T)	1
152	B130049-Q2	Gusset (R) (150×24×90×4T)	1
153	P060065-A1	Handpulse End Cap	2
156	J354507	M4 × 35m/m_Phillips Head Screw	2
157	J139411	M4_Nyloc Nut	2
158	J210028	Ø4 × Ø10 × 1.0T_Flat Washer	2
X	I030171	Console overlay-YT50/YT51/YT52/YT53	1
X	I050347	Side Poly sticker (sole TT8)	2
X	I050347A	Console Poly sticker (sole TT8)	1
X	J99A0121	guest assembly Hardware Kit	1