

ST95-YT007 Sole-Sears(美國)

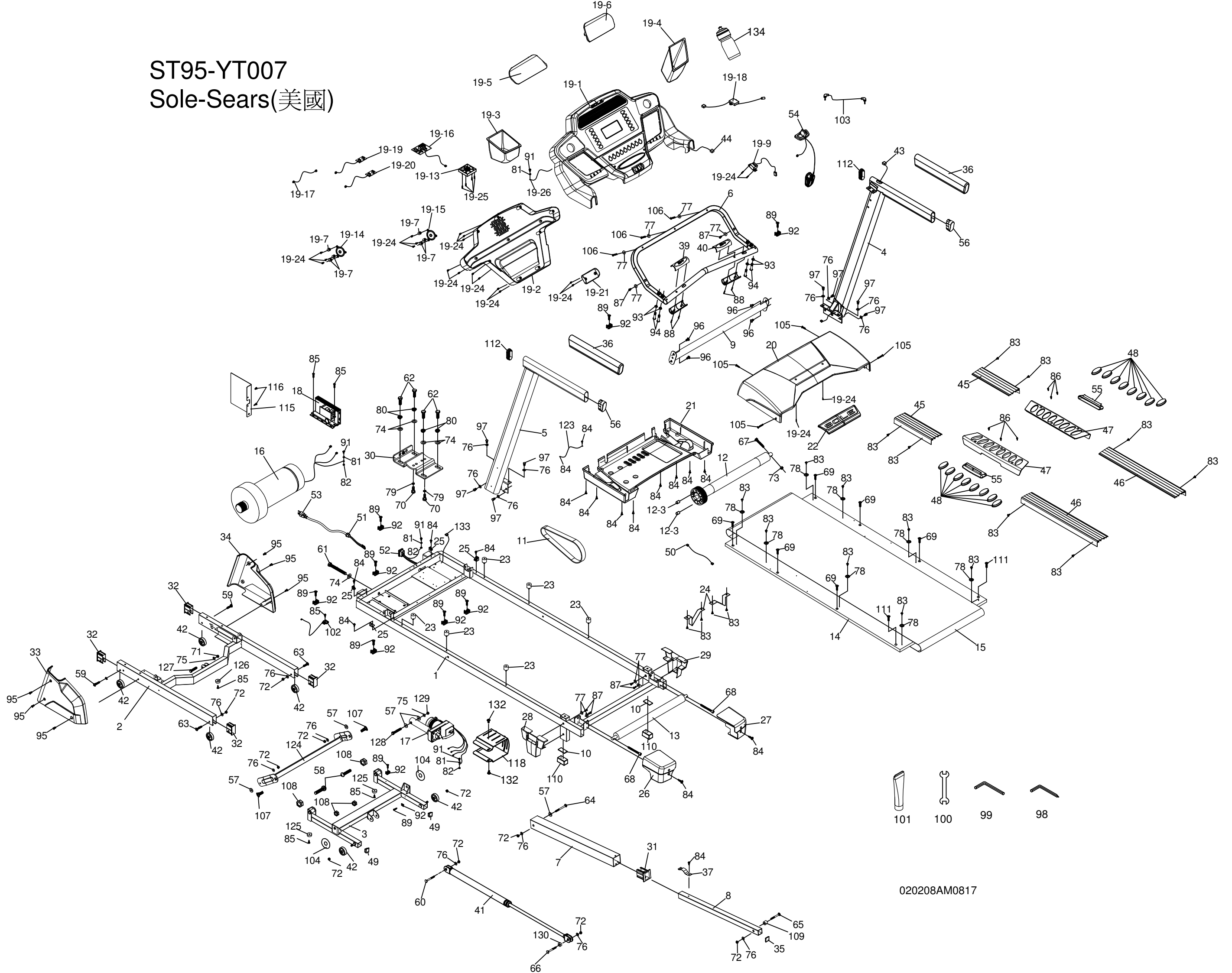

020208AM0817

SOLE - F60-560813 - PARTS LIST

Dyaco #	Material #	Detailed Descriptions	QTY
2	CRAA020046-Q2	Frame Base Assembly	1
3	AA030037-Q2	Incline Bracket	1
4	CRAA040058-Q2	Right Upright Assembly	
5	CRAA040051-Q2	Left Upright Assembly	
6	AA050021-Q2	Console Support	1
7	AA060063-Q2	Outer Slide	1
8	TT210043-Z2	Inner Slide	1
7+8	CRAA060063-Q2	Outer + Inner Slide Assembly	1
9	AA060042-Q2	Handrail Support	1
10	B010056	Foot Pad Plate	2
11	N011007	Drive Belt	1
12	K140078-Z3	Front Roller W/Pulley	1
13	K140080-Z3	Rear Roller	1
14	H140038	1410 × 700 × 18T_Running Deck	1
15	H06L3160-P5	Running Belt W/LOGO	1
15	H06L3160	Running Belt W/O LOGO	1
16	G020140A	Drive Motor	1
17	G110072	Incline Motor	1
18	D020100	Motor Controller	1
19	CRZ4YT007B-20	Console Assembly	1
019-01	P020361A-LZ-AY	Console Top Cover	1
019-02	P020362-A1	Console Bottom Cover	1
019-03	P220033-A1	Drink Bottle Holder (L)	1
019-04	P220034-A1	Drink Bottle Holder (R)	1
019-05	B130176-Z3	Speaker Iron Net (L)	1
019-06	B130177-Z3	Speaker Iron Net (R)	1
019-07	P060223-A1	Speaker Grill Anchor	6
019-08	B130062	Square Magnet Stop Plate	2
019-09	F030200	300m/m_Safety Switch Module W/ Cable	1
019-10	D021137-02	Console Display Board	1
019-11	D021138	Key Board	1
019-12	D021139	Interface Board	2
019-13	F040004	Fan Assembly	1
019-14	F050023	300m/m_Speaker W/Cable	1
019-15	F050024	750m/m_Speaker W/Cable	1
019-16	F110205	Amplifier Controller	1
019-17	E060504	300m/m_Amplifier Cable	1
019-18	D020501	300m/m_W/Receiver, HR	1
019-19	D020535	500m/m_Sound Board W/Cable (Red)	1
019-20	D020534	500m/m_Sound Board W/Cable (White)	1
019-21	P020363-A1	Safety Key Bottom Cover	1
019-22	J527201	2.3 × 6m/m	40
019-24	J396804-Y3	3.5 × 12m/m (電黒錠)	21
019-25	J396811-Y3	3.5 × 32m/m (電黒錠)	4
019-26	E040037	500m/m_Console Ground Wire	1
20	CRP010118A-A1	Motor Top Cover+ Cover Plate	1
21	P010122-A1	Bottom Motor Cover	1
22	P010120-LZ	Top Motor Cover Plate	1
23	P060294-A1	Rubber Foot	6

24	B133000-Z1	Belt Guide	2
25	P060181-A1	Motor Cover Anchor	4
26	P030096-A1	Rear Adjustment Base (L)	1
27	P030097-A1	Rear Adjustment Base (R)	1
28	P030098-A1	Rear Foot Cover (L)	1
29	P030099-A1	Rear Foot Cover (R)	1
30	AA060058-Q2	Motor Bracket	1
31	P040131-A1	Anti-Colliding Plug	1
32	P040132-A1	Metal Tube End Cap	4
33	P140039-A1	Frame Base Cover (L)	1
34	P140040-A1	Frame Base Cover (R)	1
35	P040041-A1	21.8mm × 21.8mm_Square End Cap	1
36	L030016-A1	PVC Handgrip	2
37	B130215-Z1	Sliding Tube Spring	1
39	F090240	1000m/m_Handpulse W/Cable Assembly (White)	1
40	F090241	1000m/m_Handpulse W/Cable Assembly (Red)	1
41	K060023	Cylinder	1
42	P050010-A1	Transportation Wheel	6
43	E020052	1200m/m_Computer Cable	1
44	E020002	800m/m_Computer Cable (Lower/Upper)	1
45	P080018C-A1	Running Belt Foot Rail	2
46	P080018G-A1	Running Belt Foot Rail	2
47	P130001-A1	Pedal Cover (Top)	2
48	P130002-JH	Pedal Inner Cover	16
49	P040134-A1	Square End Cap	2
50	E010757	350m/m_Connecting Wire (Black)	1
51	P060269-A1	Grommet	1
52	F030004	On/Off Switch	1
53	E060022-01	Power Cord	1
54	N100013-A5	Trapezoidal Safety Key	1
55	P060530-CA-A1	Cushion Spacer	2
56	P040019-A1	Handgrip End Cap	2
57	P060221-A1	φ24×φ10×3T_Nylon Washer (A)	5
58	J11523C1	1/2" × 60m/m (牙長10mm+束牙)	2
59	J340508C1-Y3	5/16" × 2" (牙長10mm+束牙+電黑鉸)	2
60	J020504	5/16" × 1"	1
61	J011011-Y3	3/8" × 2-3/4" (電黑鉸)	1
62	J011002-Y3	3/8" × 3/4" (電黑鉸)	4
63	J340506-Y3	5/16" × 1-1/2" (電黑鉸)	2
64	J020509-Y3	5/16" × 2-1/4" (電黑鉸)	1
65	J070530T-Y1	5/16" × 74m/m (牙長13mm+鋼製)	1
66	J070531T-Y1	5/16" × 62mm (牙長13mm+鋼製)	1
67	J013012-Y3	M8 × 60m/m (電黑鉸)	1
68	J033016-Y9	M8 × 80m/m (合金鋼)	2
69	J042505-Y3	M6 × 25m/m (電黑鉸)	6
70	J013002-Y3	M8 × 12m/m (電黑鉸)	2
71	J139011-Y3	3/8" × 7.0T (電黑鉸)	1
72	J139061-Y3	5/16" × 6.0T (電黑鉸)	10
73	J139261-Y3	M8 × 7.0T (電黑鉸)	1
74	J210008-Y3	φ25 × φ10 × 2.0T (電黑鉸)	5
75	J210003-Y3	φ19 × φ10 × 1.5T (電黑鉸)	2
76	J210005-Y3	φ5/16" × φ18 × 1.5T (電黑鉸)	8

77	J210017-Y3	φ1/4" × 19 × 1.5T (電黒鋳)	9
78	B130016-Z1	φ25 × φ20 × φ16 × φ5 × 4.5H × 1.1T (電鋳)	8
79	J260007-Y3	M8 × 1.5T (電黒鋳)	2
80	J260001-Y3	φ10 × 2.0T	4
81	J260008-Y3	M5 × 1.5T (電黒鋳)	4
82	J270001-Y3	M5 (電黒鋳)	3
83	J386904-Y3	4 × 12m/m (電黒鋳)	20
84	J367105-Y3	5 × 16m/m (電黒鋳)	17
85	J367114-Y3	5 × 19m/m (電黒鋳)	6
86	J396806-Y3	3.5 × 18m/m (電黒鋳)	6
87	J377105-Y3	5 × 16m/m (電黒鋳)	6
88	J517007-Y3	3 × 20m/m (電黒鋳)	4
89	J536805-Y3	3.5 × 16m/m (電黒鋳)	10
91	J092001-Y3	M5 × 10m/m (電黒鋳)	4
92	P060281	Wire Tie Mount	10
93	J260001-Y3	φ10 × 2T (電黒鋳)	4
94	J021006-Y3	3/8" × 1-1/2" (電黒鋳)	4
95	J092003-Y3	M5 × 15m/m (電黒鋳)	6
96	J020502-Y3	5/16" × 3/4" (電黒鋳)	4
97	J010501-Y3	5/16" × 1/2" (電黒鋳)	8
98	J330001-Y3	M5 (25 × 90mm) (電黒鋳)	1
99	J330002-Y3	M6 (66 × 88) (電黒鋳)	1
100	J330014	13mm	1
101	N020001	Lubricant	1
102	F030184	1200m/m_Sensor W/Cable	1
103	E090001	400m/m_Audio Cable	1
104	P060206-A1	φ50 × φ13 × 3T_Nylon Washer (B)	2
105	J377110-Y3	5 × 30m/m (電黒鋳)	4
106	J377111-Y3	5 × 35m/m (電黒鋳)	3
107	J071522C1-Y3	1/2" × 23m/m (電黒鋳+牙長10mm+束牙)	2
108	J139111-Y3	1/2" × 8T (電黒鋳)	4
109	C070114	Space Sleeve	1
110	P040130-A1	Square End Cap	2
111	J043005-Y3	M8 × 25m/m (電黒鋳)	2
112	P040137-A1	Oval End Cap	2
115	B070005-Z1	Controller Back Plate	1
116	J397002-Y3	3 × 8m/m (電黒鋳)	2
118	B021006	Incline Motor Cover	1
123	E040005	1000m/m_Ground Wire	1
124	AA060061-Q2	Folding Assembly Bracket	1
125	P060252-A1	φ4.5 × φ25 × 15T_Rubber Foot Pad	2
126	P060264-A1	26 × 6.5 × 10T_Rubber Foot Pad	1
127	J011066T1-Y3	3/8" × 1-1/2" (電黒鋳+牙長13mm+束牙)	1
128	J013520T1-Y3	M10 × 63m/m (電黒鋳+牙長13mm+束牙)	1
129	J139361-Y3	M10 × 8.0T (電黒鋳)	1
130	C070112	Space Sleeve	1
132	J080040-Y3	4 × 6m/m (電黒鋳)	2
133	E020005	1200m/m_Computer Cable(Lower)	1
134	N030001-A5	Drink Bottle	1
X	I140295-A4	Manual	1
X	I030188	Faceplate Label	1
X	I080856	Place Label	1

X	I080061	Power Label	1
X	I090056	SOLE Aluminum Label	1
X	I050339A	Console Bobble Label F60	1
X	I050339	Side Bobble Label (SOLE F60)	2
X	I081060	R Glue Label	1
X	I080260	Trapezoidal Safety Key Label	1
X	I900055-A1	Cartons Cover (UP)	1
X	I900056	Cartons Cover (DOWN)	1
X	I900087	Inner Frame Side Box	1
X	J99A0120	Hardware Kit- customer assembly	1