

ST120-YT006(Sole)

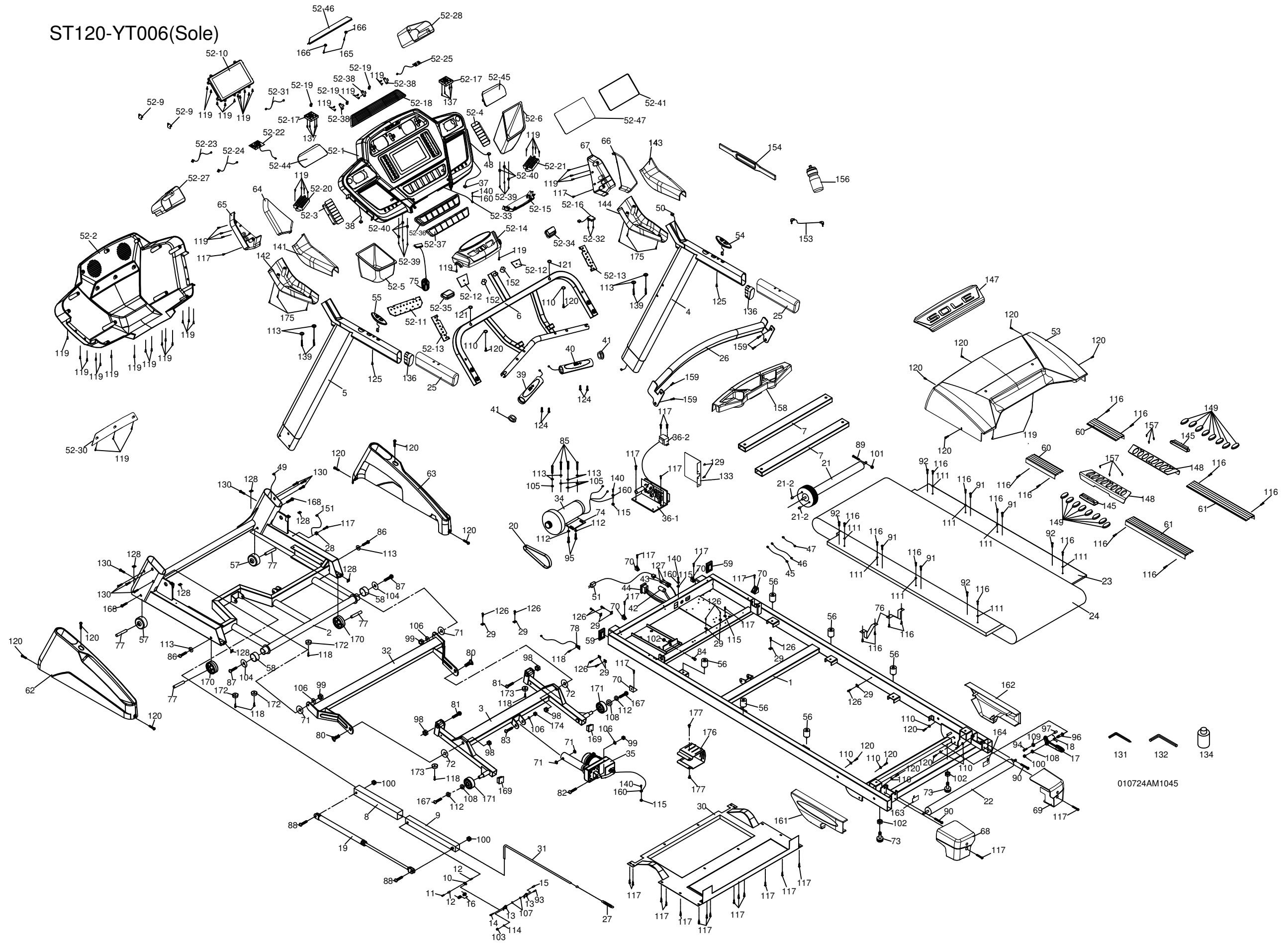

131 132 134

010724AM1045

# SOLE - F65-565812 - PARTS LIST

Dyaco #	Material #	Detailed Descriptions	QTY
1	AA010192-Q2	Main Frame	1
2	AA020083-Q2	Frame Base	1
2	RAA020083-Q2	Frame Base Assembly	1
3	AA030034-Q2	Incline Bracket	1
3	RAA030034-Q2	Incline Bracket Assembly	1
4	AA040066-Q2	Right Upright	1
4	RAA040066-Q2	Right Upright Assembly	1
5	AA040059-Q2	Left Upright	1
5	RAA040059-Q2	Left Upright Assembly	1
6	AA050051-Q2	Console Support	1
7	AA060002-Z2	Seat Slider	1
8	AA060001-Q2	Outer Slide	1
7 + 8	RAA060001A-Q2	Inner Slide + outer slide assembly	1
9	C040005-Z1	Clevis Pin(Ø5×Ø8×25mm)	1
10	C070026-Z1	Fastening Bushing(Ø5.2×Ø8×9mm)	1
11	C010003-Z1	Link Shaft(Ø8×30mm)	1
12	C070025-Z1	Shaft Bushing(Ø8.2×Ø12.7×11.5L)	2
13	B020002-Z1	Fastening Bracket(35×27×2.0T)	2
14	B020001-Z1	Link(31×14×2.0T)	1
15	AA060129-Q2	Handrail Support	1
16	K010001	Dual Torsion-Spring(Ø0.9)	1
17	P060219-A7	Release Lever(147mm×44mm×52mm)	1
18	K010002	ChenChin Torsion-Spring(Ø1.8)	1
19	K060025	Cylinder(GS22X1-700U750-30)	1
20	N010001	Drive Belt(8J240)	1
21	K140088-Z9	Front Roller W/Pulley	1
21~3	RN040004	Magnet Assembly	2
22	K140002-Z3	Rear Roller	1
23	H150031	Running Deck(1425×614×18T)	1
24	H0613200-P5-Z2	Running Belt(510×3200×1.6T)	1
25	L030014-A1	PVC Handgrip(Ø36×76×3.0T×266mm)	2
26	TT440389-Q2	Deck Cross Brace	2
27	K010003	Steel Cable Tension Spring(Ø2.0)	1
28	AA060050-Q2	Folding Assembly Bracket	1
29	N050001	Wire Tie Mount	8
30	N020001	Lubricant	1
31	K020033	Steel Cable(黑管1080mm)	1
32	P090106-A1	Top Frame Cover(1120×675mm)	1
33	P090103-A1	Bottom Frame Cover(675×740mm)	1
34	G020164B	Drive Motor(YC743,2.5HP,90V,4000RPM,Pulley:Ø35,Terminal:600mm,Gro	1
35	G110072	Incline Motor(JS15A,N30128L,115V,Terminal1400mm)	1
36~1	D020054	Motor Controller(YJ-2300L,110V AC)	1
36~2	D022218	Adaptor(06144-1/115V(115V-12V/2A+12V/1A)EI-57)	1
37	E050058	800m/m_Speed Adjustment Switch W/Cable(Upper)(Blue)	1
38	E050079	800m/m_Incline Adjustment Switch W/Cable(Upper)(Black)	1
39	F090233	650m/m_Handpulse W/Cable Assembly(L) (Red)	1
40	F090234	650m/m_Handpulse W/Cable Assembly(R) (White)	1
41	P060065-A1	Handpulse End Cap	2
42	F020001	Breaker(A-0710W,250/125VAC,15A)	1

43	F010002	Power Socket(SS-7B-VDER-4.8)	1
44	F030001	On/Off Switch(RF1004-NBR4#W1AN,5mm,125/250VAC,16A,T85/55)	1
45	E060001	Power Cord	1
46	E010747	100m/m_Connecting Wire (Black)	1
47	E010756	350m/m_Connecting Wire (White)	1
48	E010757	350m/m_Connecting Wire (Black)	1
49	E020002	800m/m_Computer Cable(Upper/Lower)	1
50	E020073	1350m/m_Computer Cable(Lower)	1
51	E020051	1100m/m_Computer Cable(Middle)	1
52	RZ0YT50G-20	Console Assembly	1
52~1	P020338A-LZ-AT	Console Top Cover	1
52~2	P020343-A1	Console Bottom Cover	1
52~3	P170058-AC-BH	Incline Key(L)	1
52~4	P170058-AC-BJ	Speed Key Board(R)	1
52~5	P220003-A1	Drink Bottle Holder (L)	1
52~6	P220004-A1	Drink Bottle Holder (R)	1
52~7	P170056-A1	Lower Controller Button-TPR	1
52~8	P170057-AC-BK	Button Frame	1
52~9	P170053-A9-BM	Stop Key	1
52~10	P170052-A8-BL	Start Key	1
52~11	B130062	Square Magnet Stop Plate(20×14.8×7×0.3T)	2
52~12	D021124	Console Display Board(YJ-59610,7.5")	1
52~13	D021126	Key Board(YJ-5962-K1)	1
52~14	D021128	Start Key(YJ-5962-K4)	1
52~15	D021129	Stop Key(YJ-5962-K3)	1
52~16	D021127	Key Fast Board(YJ-5962-K2)	2
52~17	P020342-JH	Front Console Cover (Top)	1
52~18	P020140-A1	Front Console Cover (Bottom)	1
52~19	F030200	300m/m_Safety Switch Module W/ Cable	1
52~20	F040101	Fan Assembly(RDH8025Sx2+600mm+350mm+XHP-4)	1
52~21	P250003-A1	Deflector Fan Grill	1
52~22	P250004-A1	Fan Fixing Plate	3
52~23	F050003	550m/m_Speaker W/Cable	1
52~24	F050004	200m/m_Speaker W/Cable	1
52~25	F110204	Amplifier Controller(YJ-8509-1)	1
52~26	D020533	300m/m_Sound Board W/Cable (Red)(YJ-8510-2)	1
52~27	D020534	500m/m_Sound Board W/Cable (White)(YJ-8510-3)	1
52~28	D020501	300m/m_W/Receiver, HR(YJ-8200)	1
52~29	P060060-A1	Fan Grill Anchor	3
52~30	J396811	3.5 × 32m/m_Sheet Metal Screw	8
52~31	E060502	600m/m_Amplifier Cable	1
52~32	P020340-A1	Speaker Cover (L)	1
52~33	P020341-A1	Speaker Cover (R)	1
52~36	P020344-LZ	Console Bottom Cover	1
52~37	J397003	3 × 10m/m_Sheet Metal Screw	2
52~38	B130158-Z3	Speaker Iron Net (L)(157×75×0.5T)	1
52~39	B130159-Z3	Speaker Iron Net (R)(157×75×0.5T)	1
52~40	E040010	400m/m_Console Ground Wire	1
52~43	P020256	LCD Transparent Piece(115×202×2T)	1
52~44	P060423	7.5" Water-resist Rubber	1
52~45	P020339-AC	Book Rack	1
53	P010082-A1	Motor Top Cover	1

53	RP010082A-A1	Motor Top Cover+ logo plate	1
54	N110007A	300m/m_Speed Adjustment Switch W/Cable	1
55	N110002A	300m/m_Incline Adjustment Switch W/Cable	1
56	P060019-A1	M8 × Ø30 × 35m/m_Cushion	4
57	P050002-A1	Ø75 × 35L_Transportation Wheel(A)	2
58	P050007-A1	Ø62 × Ø32 × 30L_Transportation Wheel(B)	2
59	P080007B-A1	Foot Rail Cap (L)	1
60	P080008B-A1	Foot Rail Cap (R)	1
61	P050005-A1	Ø60 × 34.5L_Transportation Wheel	2
62	P040134-A1	Square End Cap(30×30)	2
63	P070142-A1	Left Handgrip Side Cap (Top)	1
65	P070143-A1	Left Handgrip Side Cap (Bottom)	1
66	P070144-A1	Right Handgrip Side Cap (Top)	1
67	P070145-A1	Right Handgrip Side Cap (Bottom)	1
68	P030066-A1	Rear Adjustment Base (L)	1
69	P030067-A1	Rear Adjustment Base (R)	1
70	P060021-A1	Motor Cover Anchor(D)	2
71	P060221-A1	Ø24 × Ø10 × 3T_Nylon Washer (A)	4
72	P060206-A1	Ø50 × Ø13 × 3T_Nylon Washer (B)	2
73	P060018-A1	Adjustment Foot Pad(37mm×3/8)	2
74	E040026	1000m/m_Ground Wire (Black)	1
75	N100028-A5	Trapezoidal Safety Key	1
76	B134000-Z1	Belt Guide(130×25×70H×1.5T)	2
77	C070031-Z4	Wheel Sleeve(Ø10×Ø14×35.5mm)	4
78	F030191	1200m/m_Sensor W/Cable	1
79	M010008C-Z0	Aluminum Foot Rail(90×17×1380mm)	2
80	J071522C1-Y3	1/2" × 23m/m_Carriage Bolt	2
81	J011523C1-Y3	1/2" × 60m/m_Hex Head Bolt	2
82	J011006T1-Y3	3/8" × 1-1/2" _Hex Head Bolt	1
83	J013514S1-Y3	M10 × 65m/m_Hex Head Bolt	1
84	J011006-Y3	3/8" × 1-1/2" _Hex Head Bolt	1
85	J011005-Y3	3/8" × 1-1/4" _Hex Head Bolt	4
86	J341008-Y3	3/8" × 2" _Flat Head Socket Bolt	2
87	J020504-Y3	5/16" × 1" _Button Head Socket Bolt	2
88	J020511A-Y3	5/16" × 2-3/4" _Button Head Socket Bolt	2
89	J013012-Y3	M8 × 60m/m_Hex Head Bolt	1
90	J033016-Z4	M8 × 80m/m_Socket Head Cap Bolt	2
92	J043005-Y3	M8 × 25m/m_Flat Head Countersink Bolt	4
93	J354001-Z1	M3 × 10m/m_Phillips Head Screw	1
94	J092004-Z1	M5 × 20m/m_Phillips Head Screw	1
95	J043009A-Y3	M8 × 45m/m_Flat Head Countersink Bolt	4
96	J020524A-Y3	5/16" × 42m/m_Button Head Socket Bolt	1
97	J139161-Y3	M5 × 5.0T_Nyloc Nut	1
98	J139111-Y3	1/2" × 8.0T_Nyloc Nut	4
99	J139011-Y3	3/8" × 7.0T_Nyloc Nut	3
100	J139061-Y3	5/16" × 6.0T_Nyloc Nut	3
101	J139261-Y3	M8 × 7.0T_Nyloc Nut	1
102	J129021-Y3	3/8" × 7.0T_Nut	3
103	J129221-Z1	M3 × 2.5T_Nut	1
104	J210001-Y3	Ø5/16" × Ø35 × 1.5T_Flat Washer	2
105	J210008-Y3	Ø10 × Ø25 × 2.0T_Flat Washer	4
106	J210003-Y3	Ø10 × Ø19 × 1.5T_Flat Washer	6

107	J210004-Y3	Ø5 × Ø10 × 1.0T_Flat Washer	2
108	J210005-Y3	Ø5/16" × Ø18 × 1.5T_Flat Washer	3
109	J210006-Y3	Ø5 × Ø12 × 1.0T_Flat Washer	1
110	J210007-Z1	Ø5 × Ø15 × 1.0T_Flat Washer	8
111	P060404	Ø6 × Ø23 × Ø13 × 5.5T × 3.0T_Nylon Dished Washer	4
112	B130013-Z1	Ø5.5 × 27 × 60 × 1T × 2.5H_Concave Washer	4
113	J260001-Y3	Ø10 × 2.0T_Spring Washer	10
114	J260002-Z1	M3_Spring Washer	1
115	J270001-Z1	M5_Star Washer	4
116	J386904-Y3	4 × 12m/m_Sheet Metal Screw	4
117	J367105-Y3	5 × 16m/m_Tapping Screw	59
118	J367114-Y3	5 × 19m/m_Tapping Screw	4
120	J377105-Y3	5 × 16m/m_Tapping Screw	19
121	J210028-Z1	Ø4 × Ø10 × 1.0T_Flat Washer	2
122	J396804-Y3	3.5 × 12m/m_Sheet Metal Screw	54
124	J517003-Y3	3 × 10m/m_Tapping Screw	4
125	J526914-Y3	4 × 50m/m_Sheet Metal Screw	2
126	J536805-Z1	3.5 × 16m/m_皿頭十字鑽尾	8
127	J547003-Z1	3 × 10m/m_Sheet Metal Screw	2
128	J160001-Y3	M5_Speed Nut Clip	6
130	J020501-Y3	5/16" × 1/2" _Button Head Socket Bolt	8
131	J330001-Y3	M5_Combination M5 Allen Wrench & Phillips Head Screw Driver	1
132	J330002-Y3	M6_L Allen Wrench	1
133	J021007-Y3	3/8" × 1-3/4" _Button Head Socket Bolt	4
134	J092001-Y3	M5 × 10m/m_Phillips Head Screw	4
135	J397002-Y3	3 × 8m/m_Sheet Metal Screw	8
136	B070004-Z1	Controller Back Plate(140×110×25×1.5T)	1
137	P070142-A1	Left Connecting Cap (Top)	1
138	P070143-A1	Left Connecting Cap (Bottom)	1
139	P070144-A1	Right Connecting Cap (Top)	1
140	P070145-A1	Right Connecting Cap (Bottom)	1
141	P010081A-LZ	Top Motor Cover Plate	1
142	F090001-A3	Chest Strap(TX-1) SOLE LOGO	1
143	P060072B-A1	Front Motor Cover	1
144	P040019-A1	Handgrip End Cap(Ø30×70)	2
145	P280010-A1	Ø13m/m_Bolt Cap	2
146	E090010	400m/m_Audio Cable	1
147	P060183-A1	Speaker Grill Anchor(Ø12×5.5T)	6
149	N030001-A5	Drink Bottle(CSB-501,SOLE LOGO)	1
150	P220013-A1	Beverage Holder	1
151	J020502-Y3	5/16" × 3/4" _Button Head Socket Bolt	4
152	J260008-Y3	M5 × 1.5T_Spring Washer	4
153	P030071-A1	LOGO Cover (R)	1
153	RP030070D-A1	LOGO Cover (R)+ poly sticker	1
154	P030070-A1	LOGO Cover (L)	1
154	RP030071D-A1	LOGO Cover (L)+ poly sticker	1
155	N050002	Wire Clamp	1
156	P050034-A1	Ø54 × 25m/m_Transportation Wheel	2
157	P090069-A1	Rear Roller Cover (L)(40×38×1.0T)	1
158	P090070-A1	Rear Roller Cover (R)(40×38×1.0T)	1
159	P060264-A1	26.5 × 6 × 10T_Rubber Foot Pad	3
160	P060550-A1	M8 × Ø30 × 35m/m_Cushion	2

<b>161</b>	P140019-A1	Frame Base Cover (L)	1
<b>162</b>	P140020-A1	Frame Base Cover (R)	1
<b>164</b>	J020501-Y3	5/16" × 1/2" Button Head Socket Bolt	2
<b>165</b>	J341009C1-Y3	3/8" × 2-1/4" Flat Head Socket Bolt	2
<b>166</b>	J139361-Y3	M10 × 8.0T Nyloc Nut	1
<b>167</b>	P060252-A1	Ø25 × Ø25 × 15T Rubber Foot Pad	2
<b>168</b>	J396805-Y3	3.5 × 16m/m Sheet Metal Screw	6
<b>169</b>	B130194-Q2	Incline Motor Back Plate	1
<b>170</b>	J080040-Y3	4 × 6m/m Phillips Head Trilobular Screw	1
<b>172</b>	P060551-A1	Incline Motor Cover	1
<b>173</b>	J080041-Y3	4 × 10m/m Phillips Head Trilobular Screw	1
<b>X</b>	I030171	Console Lower Faceplate Label	1
<b>X</b>	I050311C	Side Bobble Label (sole F65)	2
<b>X</b>	I050310C	Console Bobble Label (sole F65)	1
<b>X</b>	I500081-A1	Cartons Cover ( UP )	1
<b>X</b>	I500082	Cartons Cover ( DOWN )	1
<b>X</b>	J99A0112	Guest Assembly screw	1
<b>X</b>	I030174	Console overlay	1
<b>X</b>	I900053-A1	Cartons ( Top )	1
<b>X</b>	J99A0119	Guest Assembly screw	1