

ST920-YT53-01  
SOLE LA

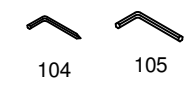
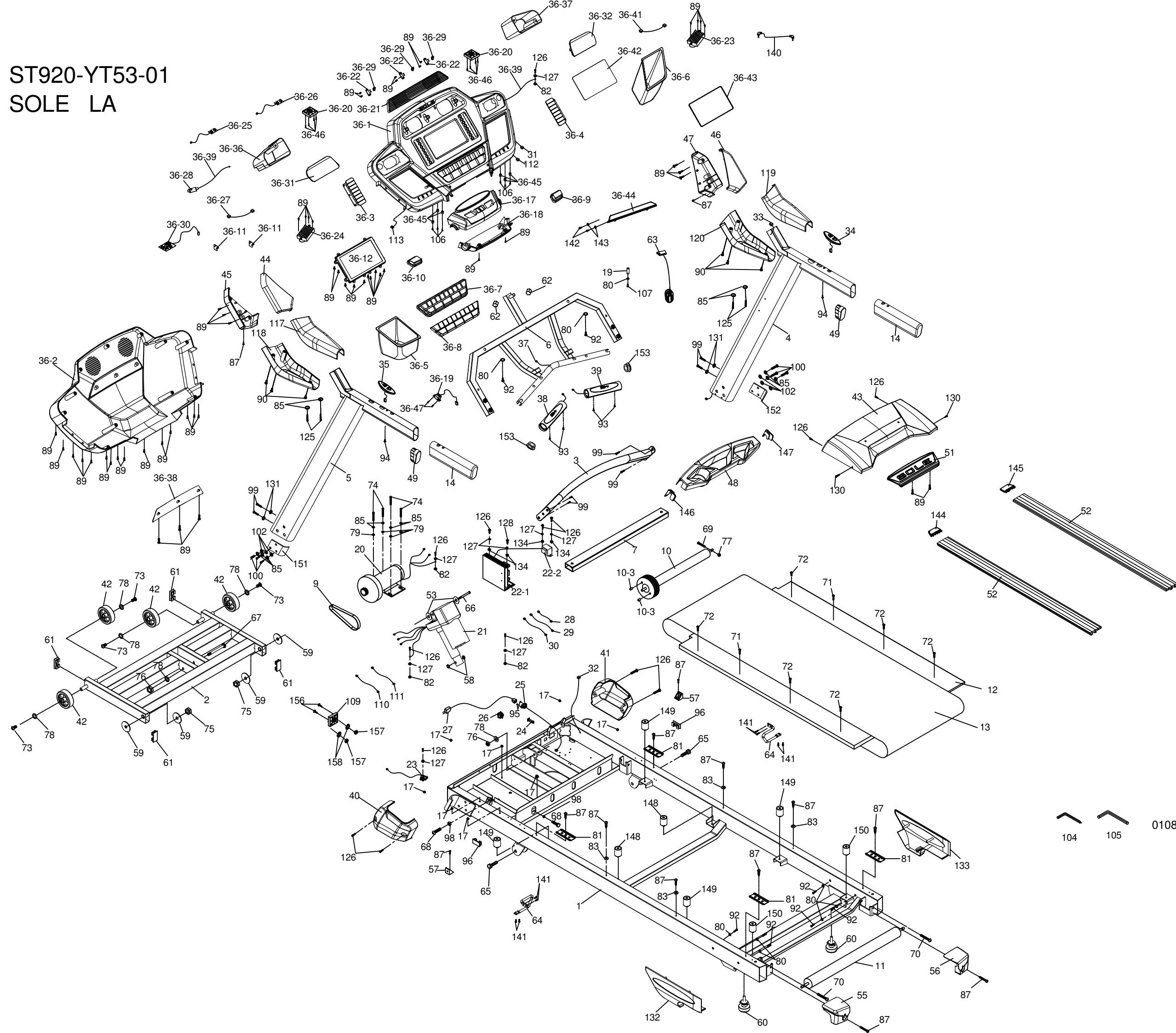

010813AM0232

# SOLE - TT8-588812 - PARTS LIST

| Dyaco # | Material #     | Detailed Descriptions  | QTY |
|---------|----------------|--|-----|
| 1       | AA010109-Q2    | Main Frame   | 1   |
| 2       | AA030027-Q2    | Incline Bracket  | 1   |
| 2       | RAA030027-Q2   | Incline Bracket assembly   | 1   |
| 3       | AA060066-Q2    | Handrail Support   | 1   |
| 4       | AA040098-Q2    | Right Upright  | 1   |
| 4       | RAA040098-Q2   | Right Upright assembly   | 1   |
| 5       | AA040065-Q2    | Left Upright   | 1   |
| 5       | RAA040065-Q2   | Left Upright assembly  | 1   |
| 6       | AA050031-Q2    | Console Support  | 1   |
| 7       | TT440019-Q2    | Deck Cross Brace   | 1   |
| 9       | N010001        | Drive Belt-(8J240)   | 1   |
| 10      | K140040-Z9     | W/Pulley-Ø75×647m/m  | 1   |
| 11      | K140004-Z9     | Rear Roller-Ø75×590m/m   | 1   |
| 12      | H180004A-A1    | Running Deck-(1410 × 680 × 25T)  | 1   |
| 13      | H0743255-P5-Z2 | Running Belt-(560 × 3255 × 2.5T)   | 1   |
| 14      | L030014-A1     | PVC Handgrip-(Ø36×76×3.0T×266m/m)  | 2   |
| 17      | P060389        | Clevis Pin Bracket   | 8   |
| 19      | C077002-Z1     | Safety Key Sleeve-(Ø10×Ø4.5×22m/m)   | 1   |
| 20      | G020077B       | Drive Motor-(YC783,3.0HP,90V,4200RPM,φ31,650m/m,Ground Wire250m/m,Label:4.0HP) | 1   |
| 21      | G110063        | Incline Motor-(TM01-024,JS25A,N50198L,115V,1/6HP,350m/m,400m/m)                | 1   |
| 22-1    | D020055        | Motor Controller-(YJ-2350L,3.5HP)  | 1   |
| 22-2    | D022028        | Adaptor-(06144/115V(115V-12V/2A+12V/1A)EI-57)                                  | 1   |
| 23      | F030191        | 1200m/m_Sensor W/Cable   | 1   |
| 24      | F020001        | Breaker-(A-0710W,250/125VAC,15A)   | 1   |
| 25      | F010002        | Power Socket-(SS-7B-VDER-4.8)  | 1   |
| 26      | F030001        | On/Off Switch-(RF1004-NBR4#W1AN,5mm,125/250VAC,16A,T85/55)                     | 1   |
| 27      | E060001        | Power Cord   | 1   |
| 28      | E010747        | 100m/m_Connecting Wire (Black)   | 1   |
| 29      | E010756        | 350m/m_Connecting Wire (White)   | 1   |
| 30      | E010757        | 350m/m_Connecting Wire (Black)   | 1   |
| 31      | E020002        | 800m/m_Computer Cable (Upper/Lower)  | 1   |
| 32      | E020016        | 550m/m_Computer Cable (Upper/Lower)  | 1   |
| 33      | E020052        | 1200m/m_Computer Cable   | 1   |
| 34      | N110007A       | 300m/m_Speed Adjustment Switch W/Cable   | 1   |
| 35      | N110002A       | 300m/m_Incline Adjustment Switch W/Cable                                       | 1   |
| 36      | RZ0YT53A-20    | Console Assembly   | 1   |
| 36-1    | P020338B-LZ-AT | Console Top Cover  | 1   |
| 36-2    | P020343-A1     | Console Bottom Cover   | 1   |
| 36-3    | P170058-AC-BH  | INCLINE Key(L)   | 1   |
| 36-4    | P170058-AC-BJ  | SPEED Key(R)   | 1   |
| 36-5    | P220003-A1     | Drink Bottle Holder (L)  | 1   |
| 36-6    | P220004-A1     | Drink Bottle Holder (R)  | 1   |
| 36-7    | P170056-A1     | Lower Controller Button-TPR  | 1   |
| 36-8    | P170057-AC-BT  | Button Frame   | 1   |
| 36-9    | P170053-A9-BM  | STOP Key-(185C)  | 1   |
| 36-10   | P170052-A8-BL  | START Key  | 1   |
| 36-11   | B130062        | Square Magnet Stop Plate-(20×14.8×7×0.3T)                                      | 2   |
| 36-12   | D021141        | Console Display Board-(P020250)  | 1   |

|       |             |   |   |
|-------|-------------|---|---|
| 36-13 | D021126     | Key Board-(YJ-5962-K1)                      | 1 |
| 36-14 | D021128     | START Key-(YJ-5962-K4)                      | 1 |
| 36-15 | D021129     | STOP Key-(YJ-5962-K3)                       | 1 |
| 36-16 | D021127     | Key Fast Board-(YJ-5962-K2)                 | 2 |
| 36-17 | P020342-JH  | Front Console Cover (Top)                   | 1 |
| 36-18 | P020140-A1  | Front Console Cover (Bottom)                | 1 |
| 36-19 | F030200     | 300m/m_Safety Switch Module W/ Cable        | 1 |
| 36-20 | F040101     | Fan Assembly-(RDH8025Sx2+600mm+350mm+XHP-4) | 1 |
| 36-21 | P250003-A1  | Deflector Fan Grill                         | 1 |
| 36-22 | P250004-A1  | Fan Grill Anchor                            | 3 |
| 36-23 | F050003     | 550m/m_Speaker W/Cable(Optional)            | 1 |
| 36-24 | F050004     | 200m/m_Speaker W/Cable(Optional)            | 1 |
| 36-25 | D020533     | 300m/m_Sound Board W/Cable (Red)            | 1 |
| 36-26 | D020534     | 500m/m_Sound Board W/Cable (White)          | 1 |
| 36-27 | E030083     | 400m/m_HR monitor module W/Cable            | 1 |
| 36-28 | F090108     | (Salutron) HR monitor module(4600 I-pulse)  | 1 |
| 36-29 | P060060-A1  | Fan Grill Anchor                            | 3 |
| 36-30 | F110204     | Amplifier Controller(Optional)              | 1 |
| 36-31 | B130158-Z3  | Speaker Iron Net (L)                        | 1 |
| 36-32 | B130159-Z3  | Speaker Iron Net (R)                        | 1 |
| 36-36 | P020340-A1  | Speaker Cover (L)                           | 1 |
| 36-37 | P020341-A1  | Speaker Cover (R)                           | 1 |
| 36-38 | P020344-LZ  | Console Bottom Cover                        | 1 |
| 36-39 | E040010     | 400m/m_Console Ground Wire                  | 2 |
| 36-41 | E060502     | 600m/m_Amplifier Cable(Optional)            | 1 |
| 36-42 | P020256     | LCD Transparent Piece-(115×202×2T)          | 1 |
| 36-43 | P060424     | 9" Water-resist Rubber                      | 1 |
| 36-44 | P020339-AC  | Book Rack-(A-BK)                            | 1 |
| 36-45 | P060183-A1  | Speaker Grill Anchor-(Ø12×5.5T)             | 6 |
| 36-46 | J396811     | 3.5 × 32m/m_Sheet Metal Screw(Optional)     | 8 |
| 36-47 | J397003     | 3 × 10m/m_Sheet Metal Screw                 | 2 |
| 37    | E030094     | 150m/m_Handpulse Wire                       | 1 |
| 38    | F090242     | 400m/m_Handpulse W/Cable Assembly           | 1 |
| 39    | F090243     | 400m/m_Handpulse W/Cable Assembly           | 1 |
| 40    | P140037-A1  | Frame Base Cover (L)                        | 1 |
| 41    | P140038-A1  | Frame Base Cover (R)                        | 1 |
| 42    | P050004-A1  | Transportation Wheel-(Ø82×Ø14×35m/m)        | 4 |
| 43    | P010117-A1  | Motor Top Cover                             | 1 |
| 44    | P070150-A1  | Left Connecting Cap (Top)                   | 1 |
| 45    | P070151-A1  | Left Connecting Cap (Bottom)                | 1 |
| 46    | P070152-A1  | Right Connecting Cap (Top)                  | 1 |
| 47    | P070153-A1  | Right Connecting Cap (Bottom)               | 1 |
| 48    | P220013-A1  | Beverage Holder                             | 1 |
| 49    | P040019-A1  | Handgrip End Cap-(Ø30×70)                   | 2 |
| 51    | P010116-LZ  | Top Motor Cover Plate                       | 1 |
| 52    | M010009B-Z0 | Foot Rail-(105×27.5×1350m/m)                | 2 |
| 53    | P060410-A1  | Ø10 × Ø25 × 0.8T_Nylon Washer               | 2 |
| 55    | P030068B-A1 | Rear Adjustment Base (L)                    | 1 |
| 56    | P030069B-A1 | Rear Adjustment Base (R)                    | 1 |
| 57    | P060021-A1  | Motor Cover Anchor(D)                       | 2 |
| 58    | P060221-A1  | Ø24 × Ø10 × 3T_Nylon Washer (A)             | 2 |
| 59    | P060206-A1  | Ø50 × Ø13 × 3T_Nylon Washer (B)             | 4 |

|     |             |  |    |
|-----|-------------|--|----|
| 60  | P270012     | Foot Pad-Ø50(3/8"-16UNC)                                 | 2  |
| 61  | P040039-A1  | 25m/m × 50m/m_Square End Cap                             | 4  |
| 62  | P280010-A1  | Bolt Cap-(Ø13mm)   | 2  |
| 63  | N100029-A5  | 800m/m+300m/m_Trapezoidal Safety Key                     | 1  |
| 64  | C120300-ZL  | Belt Guide-(Ø8×220m/m)                                   | 2  |
| 65  | J031509Q    | 1/2" × 2-1/2" _Socket Head Cap Bolt                      | 2  |
| 66  | J031007U-Y9 | 3/8" × 1-3/4" _Socket Head Cap Bolt (Alloy Steel)        | 1  |
| 67  | J031016G-Y9 | 3/8" × 4" _Socket Head Cap Bolt (Alloy Steel)            | 1  |
| 68  | J011006-Y3  | 3/8" × 1-1/2" _Hex Head Bolt                             | 2  |
| 69  | J013012-Y3  | M8 × 60m/m _Hex Head Bolt                                | 1  |
| 70  | J033016     | M8 × 80m/m _Socket Head Cap Bolt                         | 2  |
| 71  | J043011R-Z4 | M8 × 55m/m _Flat Head Countersink Bolt                   | 2  |
| 72  | J043007-Y3  | M8 × 35m/m _Flat Head Countersink Bolt                   | 6  |
| 73  | J021002-Y3  | 3/8" × 3/4" _Button Head Socket Bolt                     | 4  |
| 74  | J011005-Y3  | 3/8" × 1-1/4" _Hex Head Bolt                             | 4  |
| 75  | J139112-Y3  | 1/2" × 15T _Nyloc Nut                                    | 2  |
| 76  | J139011-Y3  | 3/8" × 7.0T _Nyloc Nut                                   | 2  |
| 77  | J139261-Y3  | M8 _Nyloc Nut  | 1  |
| 78  | J210003-Y3  | Ø19 × Ø10 × 1.5T _Flat Washer                            | 6  |
| 79  | J210008-Y3  | Ø25 × Ø10 × 2.0T _Flat Washer                            | 4  |
| 80  | J210007-Z1  | Ø3/16" × Ø15 × 1.0T _Flat Washer                         | 9  |
| 81  | B130013-Z1  | Ø5.5 × 27 × 60 × 1T × 2.5H _Concave Washer               | 4  |
| 82  | J270001-Z1  | M5 _Star Washer  | 4  |
| 83  | J570002-Z1  | Ø6.5 × 25 × 1.5T × 5.8H _Main Frame                      | 4  |
| 85  | J260003-Y3  | 3/8" × 2.0T _Split Washer                                | 14 |
| 87  | J367105-Y3  | 5 × 16m/m _Tapping Screw                                 | 16 |
| 89  | J396804-Y3  | 3.5 × 12m/m _Sheet Metal Screw                           | 32 |
| 90  | J396805-Y3  | 3.5 × 16m/m _Sheet Metal Screw                           | 4  |
| 92  | J377105-Y3  | 5 × 16m/m _Tapping Screw                                 | 10 |
| 93  | J517003-Y3  | 3 × 10m/m _Tapping Screw                                 | 4  |
| 94  | J526914-Y3  | 4 × 50m/m _Sheet Metal Screw                             | 2  |
| 95  | J547003-Z1  | 3 × 10m/m _Sheet Metal Screw                             | 2  |
| 96  | P040038-A1  | 20m/m × 40m/m_Square End Cap                             | 2  |
| 98  | J129021-Y3  | 3/8" _Nut  | 2  |
| 99  | J340502-Y3  | 5/16" × 3/4" _Flat Head Socket Bolt                      | 8  |
| 100 | J021009S-Y3 | 3/8" × 2-1/4" _Button Head Socket Bolt(M6)               | 6  |
| 102 | J210003-Y3  | Ø10 × Ø19 × 1.5T _Flat Washer                            | 6  |
| 104 | J330001-Y3  | Combination M5 Allen Wrench & Phillips Head Screw Driver | 1  |
| 105 | J330002-Y3  | M6 _L Allen Wrench                                       | 1  |
| 106 | J397002     | 3 × 8m/m _Sheet Metal Screw                              | 6  |
| 107 | J396813     | 3.5 × 40m/m _Sheet Metal Screw                           | 1  |
| 109 | F040011     | Fan-(P1082HST,115V,50/60HZ,3.5/4.5W)                     | 1  |
| 110 | E010049     | 300m/m _Motor Fan Connecting Cable (Black)               | 1  |
| 111 | E010050     | 300m/m _Motor Fan Connecting Cable (White)               | 1  |
| 112 | E050058     | 800m/m _Speed Cable (Upper)                              | 1  |
| 113 | E050079     | 800m/m _Incline Cable (Upper)                            | 1  |
| 117 | P070142-A1  | Left Handgrip Side Cap (Top)                             | 1  |
| 118 | P070143-A1  | Left Handgrip Side Cap (Bottom)                          | 1  |
| 119 | P070144-A1  | Right Handgrip Side Cap (Top)                            | 1  |
| 120 | P070145-A1  | Right Handgrip Side Cap (Bottom)                         | 1  |
| 121 | J210028-Z1  | Ø4 × Ø10 × 1.0T _Flat Washer                             | 2  |
| 125 | J021007-Y3  | 3/8" × 1-3/4" _Button Head Socket Bolt                   | 4  |

|     |             |                                     |    |
|-----|-------------|-------------------------------------|----|
| 126 | J092001-Y3  | M5 × 10m/m_Phillips Head Screw      | 13 |
| 127 | J260008     | M5_Split Washer                     | 9  |
| 128 | J092004     | M5 × 20m/m_Phillips Head Screw      | 2  |
| 131 | J220001-Y3  | Ø8 × Ø23 × 1.5T_Curved Washer       | 4  |
| 132 | P030072-A1  | Logo Cover (L)                      | 1  |
| 132 | RP030072-A1 | Logo Cover (L)+poly sticker         | 1  |
| 133 | P030073-A1  | Logo Cover (R)                      | 1  |
| 133 | RP030073-A1 | Logo Cover (R)+poly sticker         | 1  |
| 134 | J210006     | Ø5 × Ø12 × 1.0T_Flat Washer         | 4  |
| 140 | E090010     | 400m/m_Audio Cable                  | 1  |
| 141 | J367114-Y3  | 5 × 19m/m_Tapping Screw             | 8  |
| 142 | J396801-Y3  | 3.5 × 6m/m_Sheet Metal Screw        | 2  |
| 144 | P080044-A1  | Foot Rail Cap (L)                   | 1  |
| 145 | P080045-A1  | Foot Rail Cap (R)                   | 1  |
| 146 | P220028-A1  | Beverage Holder Cover(L)            | 1  |
| 147 | P220029-A1  | Beverage Holder Cover(R)            | 1  |
| 148 | P060406-AE  | Cushion (Gray)-(M8×Ø30×37m/m)       | 2  |
| 149 | P060407-A8  | Cushion (Green)-(M8×Ø30×37m/m)      | 4  |
| 150 | P060408-A1  | Cushion (Black)-(M8×Ø30×37m/m)      | 2  |
| 151 | B130048-Q2  | Gusset (L) (150×24×90×4T)           | 1  |
| 152 | B130049-Q2  | Gusset (R) (150×24×90×4T)           | 1  |
| 153 | P060065-A1  | Handpulse End Cap                   | 2  |
| 156 | J354507     | M4 × 35m/m_Phillips Head Screw      | 2  |
| 157 | J139411     | M4_Nyloc Nut                        | 2  |
| 158 | J210028     | Ø4 × Ø10 × 1.0T_Flat Washer         | 2  |
| X   | I030171     | Console overlay-YT50/YT51/YT52/YT53 | 1  |
| X   | I050347     | Side Poly sticker (sole TT8)        | 2  |
| X   | I050347A    | Console Poly sticker (sole TT8)     | 1  |
| X   | J99A0121    | guest assembly Hardware Kit         | 1  |