

研發部
2013.11.29
出圖章

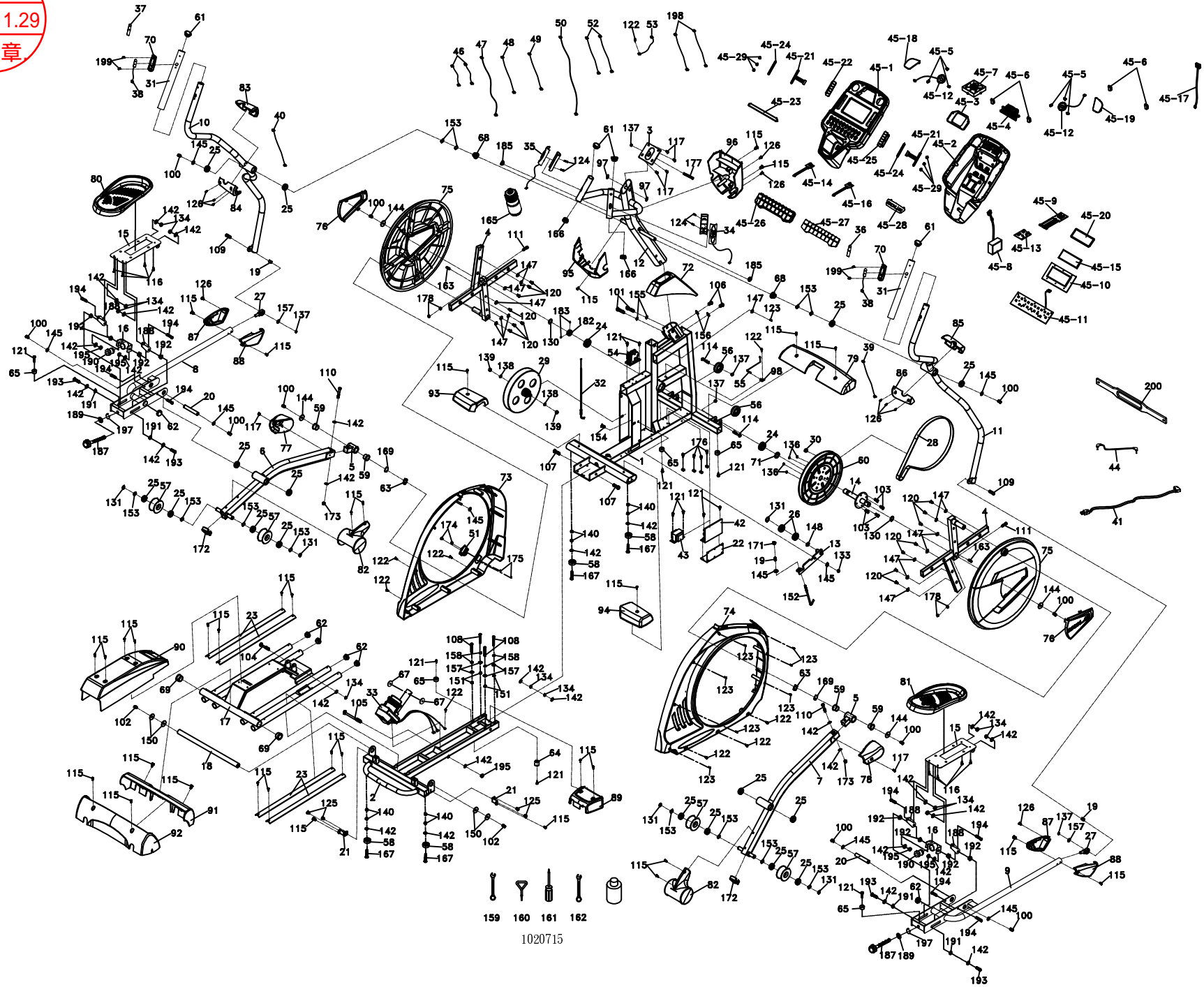

159 160 161 162

1020715

SOLE - E55 - 555013 - PARTS LIST

Dyaco#	Material #	Detailed Descriptions	QTY
1	BB010023-Q2	Main Frame	1
2	RBB030050-Q2	Rail Base Assembly	1
3	BB080004-Q2	Console Holder Assembly	1
4	BB040011-Q2	Cross Bar	2
5	RBB070056-Z1	Bushing Housing, Pedal Arm Assembly	2
6	RBB050068-Q2	Pedal Arm (L) Assembly	1
7	RBB050069-Q2	Pedal Arm (R) Assembly	1
8	RBB050183-Q2	Connecting Arm (L) Assembly	1
9	RBB050184-Q2	Connecting Arm (R) Assembly	1
10	RBB060011-Q2	Swing Arm (L) Assembly	1
11	RBB060012-Q2	Swing Arm (R) Assembly	1
12	RBB020087-Q2	Console Mast Assembly	1
13	RC145001-Q2	Idler Wheel Assembly	1
14	C140017	Crank Axle	1
15	BB070102-Q2	Adjustable Pedal	2
16	BB070024-Q2	Pedal Adjustment Assembly	2
17	BB030043-Q2	Rear Rail Assembly	1
18	BB070023	Locking Tube Assembly	1
19	C080008-Z1	Ø11.9 × Ø8.5 × 15m/m_Rod End Sleeve	3
20	C050008-Z4	Axle for Pedal	2
21	B130122-Q2	Cover Holder(B)	2
22	B060015-Q2	Control Fixing Plate	1
23	M030005-Z0	2.0T × 625m/m_Aluminum Rail	4
24	K056005	6005_Bearing	2
25	K056003	6003_Bearing	16
26	K056203	6203_Bearing	2
27	K056001	M12 × P1.75_Rod End Bearing	2
28	N010002	Drive Belt	1
29	K500042	Flywheel	1
30	N040002	Magnet	1
31	L120002-A1	Ø31.8 × 3T × 420m/m_Handgrip Foam	2
32	K020046	Steel Cable	1
33	G110087	650m/m_Incline Motor	1
34	F090235	850m/m_Handpulse W/Cable Assembly (White)	1
35	F090236	850m/m_Handpulse W/Cable Assembly (Red)	1
36	I080497-A2	Handgrip Resistance Label (INCLINE)	1
37	I080497-A1	Handgrip Resistance Label (LEVEL)	1
38	F090401	Resistance Button W/Cable	2
39	E050101	450m/m_Handle Wire (Upper), Resistance	1
40	E050102	450m/m_Handle Wire (Upper), Incline	1
41	E060001	Power Cord	1
42	D150602	Incline Controller	1
43	D150701	Incline Adaptor	1
44	E090001	400m/m_Audio Cable	1

45	RZ5SE0030-20	Console Assembly	1
45~1	P020349A-MA-AW	Console Top Cover	1
45~2	P020325A-A1	Console Bottom Cover	1
45~3	P250002-A1	Fan Fixing Plate	1
45~4	P250001-A1	Deflector Fan Grill	1
45~5	P060223-A1	Speaker Grill Anchor	6
45~6	P060060-A1	Fan Grill Anchor	4
45~7	F040100	400m/m_Fan Assembly(White)	1
45~8	D150401	300m/m_W/Receiver, HR	1
45~9	D150304	Interface Board	1
45~10	D150105	Console Display Board	1
45~11	D150204	Main Key Board	1
45~12	F050300	250m/m_Speaker W/Cable	2
45~13	F110502	Amplifier Controller	1
45~14	D150503	300m/m_Sound Board W/Cable (White)	1
45~15	P020256	LCD Transparent Piece	1
45~16	D150504	300m/m_Earphone Socket	1
45~17	E060503	250m/m_Amplifier Cable	1
45~18	B130091-Z3	Speaker Iron Net (L)	1
45~19	B130092-Z3	Speaker Iron Net (R)	1
45~20	P060424	9" Water-resist Rubber	1
45~21	F090405	6key Resistance Button W/Cable	2
45~22	P170069-AC-BO	Key Fast Board (L)	1
45~23	P240008-JH	Book Rack	1
45~24	P170070-A1	Key Fast Board Foam	2
45~25	P170069-AC-BP	Key Fast Board (R)	1
45~26	P170065-A1	Key Foam	1
45~27	P170067-AC-BS	Key Board Cover	1
45~28	P060529-MA	LOGO Chain Cover	1
45~29	P060183-A1	Speaker Grill Anchor	6
46	E010061	300m/m_Connecting Wire, Controller(Red)	2
47	E020105	850m/m_Computer Cable	1
48	E011018	900m/m_Connecting Wire, Incline Motor Power Cord	1
49	E021001	850m/m_Connecting Wire, Incline Motor	1
50	E020351	1550m/m_Computer Cable	1
51	F030053	AC Electronic Module	1
52	E010081	80m/m_Connecting Wire (White)	2
53	E040007	200m/m_Ground Wire	1
54	D150801	Gear Motor	1
55	F030165	400m/m_Sensor W/Cable	1
56	P050015-A1	Ø62_Transportation Wheel	2
57	RP050026-01	Slide Wheel+6003_Bearing assembly	4
58	P060256-A1	Ø35 × 10m/m_Rubber Foot	4
59	P270003	WFM-2528-21_Bushing	4
60	P060090-A1	Ø330_Drive Pulley	1
61	P060253-A1	Ø32(1.8T)_Button Head Plug	4
62	P040050-A1	32 × 2.5T_Round Cap	6
63	P060377	Ø25.5 × 33.5 × 1.5T_Nylon Wave Washer	2

64	P060279	Ø25 × 25m/m_Rubber Foot Pad	1
65	P060252	Ø25 × Ø25 × 15T_Rubber Foot Pad	5
67	P060277	3/8" × 35 × 5T_Nylon Washer	2
68	P060056-A1	Ø30 × 19m/m_Upright Bushing	2
69	P060029-A1	Ø38 × Ø34 × Ø26 × 4 + 16T_Bushing	2
70	P161002	Handle Switch Bracket	2
71	P060273-A1	Spacer Bushing	1
72	P100068-A1	Console Mast Cover	1
73	RP100066AI-A1	Side Case (L)	1
74	RP100067I-A1	Side Case (R)	1
75	P110012-I5	Round Disk	2
76	P110013-LI	Round Disk Cover	2
77	P060057-A1	Pedal Arm Cover (L)	1
78	P060058-A1	Pedal Arm Cover (R)	1
79	P190001-A1	Front Stabilizer Cover	1
80	P130015B-A1	Pedal (L)	1
81	P130016B-A1	Pedal (R)	1
82	P060162-A1	Slide Wheel Cover	2
83	P180012-A1	Front Handle Bar Cover (L)	1
84	P180013-A1	Rear Handle Bar Cover (L)	1
85	P180014-A1	Front Handle Bar Cover (R)	1
86	P180015-A1	Rear Handle Bar Cover (R)	1
87	P060079-A1	Connecting Arm Cover (L)	2
88	P060165-A1	Connecting Arm Cover (R)	2
89	P190008-A1	Incline Bottom Cover	1
90	P190026-A1	Incline Cover	1
91	P190027-A1	Inclinable Rail Cover	1
92	P190025-A1	Rear Bar Cover	1
93	P190006-A1	Middle Stabilizer Cover (L)	1
94	P190007-A1	Middle Stabilizer Cover (R)	1
95	P180087-A1	Console Chin Cover (Front)	1
96	P180088-A1	Console Chin Cover (Rear)	1
97	P060278	5/16" × 25 × 3T_Nylon Washer	2
98	P060022F-A1	Sensor Rack	1
100	J010503-ZR	5/16" × 15m/m_Hex Head Bolt	10
101	J011009-Z1	3/8" × 2-1/4" _Hex Head Bolt	2
102	J010504-Z9	5/16" × 25m/m_Hex Head Bolt	2
103	J010002-ZZ	1/4" × 3/4" _Hex Head Bolt	4
104	J011010A-YD	3/8" × 2-1/2" _Hex Head Bolt	1
105	J013513L-Y1	M10 × 130m/m_Hex Head Bolt	1
106	J011002-ZR	3/8" × 3/4" _Hex Head Bolt	2
107	J011006-Z1	3/8" × 1-1/2" _Hex Head Bolt	2
108	J010509-Z1	5/16" × 2-1/4" _Hex Head Bolt	4
109	J010505-Z1	5/16" × 1-1/4" _Hex Head Bolt	2
110	J031009D-Z4	3/8" × 2-1/4" _Socket Head Cap Bolt	2
111	J033008G-Y3	M8 × 40m/m_Socket Head Cap Bolt	2
114	J020508A-Z1	5/16" × 2" _Button Head Socket Bolt	2
115	J092003-Z1	M5 × 15m/m_Phillips Head Screw	35

116	J092001-Z9	M5 × 10m/m_Phillips Head Screw	8
117	J092001-Z1	M5 × 10m/m_Phillips Head Screw	6
120	J377105-Z1	5 × 16m/m_Tapping Screw	14
121	J367114-Z1	5 × 19m/m_Tapping Screw	12
122	J367105-Z1	5 × 16m/m_Tapping Screw	9
123	J396805-Z1	3.5 × 16m/m_Sheet Metal Screw	8
124	J517007-Z1	Ø3 × 20m/m_Tapping Screw	4
125	J352501-Z1	M6 × 10m/m_Phillips Head Screw	4
126	J396804-Z1	Ø3.5 × 12m/m_Sheet Metal Screw	10
130	J310001-Z4	Ø25_C Ring	2
131	J310002-Z4	Ø17_C Ring	5
133	J139261-ZF	M8 × 7T_Nyloc Nut	1
134	J139011-Z1	3/8" × 7T_Nyloc Nut	11
136	J139461-Z4	1/4" _Nyloc Nut	4
137	J139062F-Z1	5/16" × 7T_Nyloc Nut	5
138	J129031-Z1	3/8" -UNF26 × 4T_Nut	2
139	J160028-Z1	3/8" -UNF26 × 11T_Nut	2
140	J129021-Z1	3/8" × 7T_Nut	8
142	J210003-Z1	3/8" × 19 × 1.5T_Flat Washer	28
144	J210001-Z1	5/16" × 35 × 1.5T_Flat Washer	4
145	J210009-Z1	5/16" × 23 × 1.5T_Flat Washer	9
147	J210012-Z1	1/4" × 19m/m_Flat Washer	15
148	J210011-Z1	Ø17 × 23.5 × 1T_Flat Washer	1
150	J210014-Z1	5/16" × 35 × 2.0T_Flat Washer	4
151	J270002-Z1	Ø5/16" _Star Washer	4
152	J083012K-Z1	M8 × 170m/m_J Bolt	1
153	J250002-Z4	Ø17_Wave Washer	12
154	J073004-Z1	M8 × 20m/m_Carriage Bolt	1
155	J260003-Z1	3/8" × 2T_Spring Washer	2
156	J220002-Z1	3/8" × 23 × 2T_Curved Washer	2
157	J210010-Z1	5/16" × 20 × 1.5T_Flat Washer	6
158	J260007-Z1	Ø5/16" × 1.5T_Spring Washer	4
159	J330025-Z1	13/14m/m_Wrench	1
160	J330007-Z1	Short Phillips Head Screw Driver	1
161	J330008-Z1	Phillips Head Screw Driver	1
162	J330026-Z1	12/14m/m_Wrench	1
163	J320009-Z1	Woodruff Key	2
165	N030001-A5	Drink Bottle	1
166	P040052	Ø32 × 1.8T_Round Cap	2
167	J341008-Z1	3/8" × 2" _Flat Head Socket Bolt	4
169	J250001-Z4	Ø25_Wave Washer	2
171	J139262-Y3	M8 × 9T_Nyloc Nut	1
172	P040011-A1	Oval End Cap	2
173	J139012-Y3	3/8" × 11T_Nyloc Nut	2
174	J094502-Z1	M4 × 12m/m_Phillips Head Screw	2
175	J139411-Z1	M4 × 5T_Nyloc Nut	2
176	J536805-Z1	Ø3.5 × 16m/m_Tapping Screw	4
177	J010510A-Z1	5/16" × 2-1/2" _Hex Head Bolt	1

178	J129272-YB	M8 × 6.3T_Nyloc Nut	4
182	C110001-Z1	Axle Stopper	1
183	J080005-YH	M5 × 5m/m_Slotted Set Screw	2
185	P040036-A1	Switch Wire Cap	2
187	P210003	Pedal Adjustment Knob	2
188	B030014-Q2	Adjusting Plate	4
189	P060272-A1	16.1 × 31 × 3T_Nylon Washer	2
190	P060282-A1	Threaded Bushing	2
191	P060231-A1	Ø14 × Ø10 × 9T_Bushing	4
192	P060230-A1	Ø19 × Ø14 × Ø10 × (5+4)_Bushing	8
193	J013508-Z1	M10 × 40m/m_Hex Head Bolt	4
194	J011021-Z1	3/8" × 19m/m_Hex Head Bolt	8
195	J139361F-Z1	M10 × 8T_Nyloc Nut	5
197	J590001-Z4	E12_E-Clip	2
198	E050104	900m/m_Handle Wire (Lower), Resistance/Incline	2
199	J552004-Z1	M5 × 20m/m_Flat Head Socket Screw	4
200	F090001-A3	Chest Strap	1
X	J99B0066-01		1
X	I600024-FU	Machine Cartons for E25 2011	1
X	I030173	Faceplate	1
X	I090150	Guest Assembly screw	1
X	I080459	Chain Cover label	1
X	I080021	Pedal Knob Label	2
X	I050378	Side Bobble Label	2
X	I050378A	Console Bobble Label	1