

SB900-GS

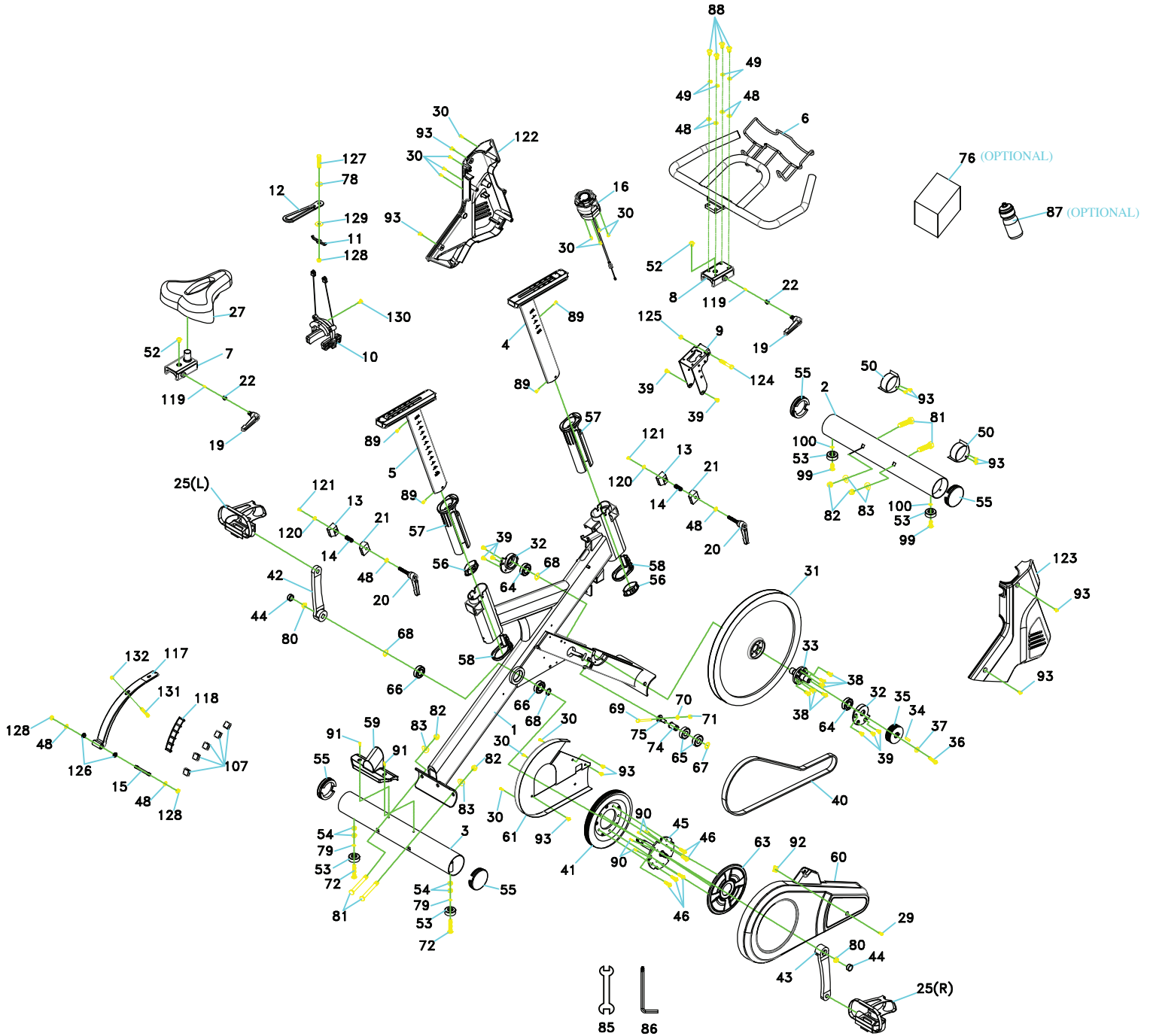

1030422AM1030

SB900GS-3260N-01 Part List_SOLE			
組立		Part Name	#
1		Main Frame	1
2		Front Stabilizer	1
3		Rear Stabilizer	1
4		Handlebar Post	1
5		Seat Post	1
6		Handlebar	1
7		Seat Post Bracket	1
8		Handlebar Adapter	1
9		Cable Device Mount	1
10		Cable Fix	1
11		Cable Hook	1
12		Braking Handle	1
13		Aluminum Locking V-Blocks(L)	2
14		Spring	2
15		Shaft	1
16		Non-segment Knob	1
19		M10 × 12L Seat/Handlebar Adj. Locking Lever	2
20		M8 × 46L Seat/Handlebar Adj. Locking Lever	2
21		Aluminum Locking V-Blocks(36×31×19.5L)	2
22		Latch(Ø11×8.7L)	2
25		Pedal Set (25L.25R)	1
27		Seat	1
29		Ø5 × 16L Tapping Screw	1
30		Ø3.5 × 12L Sheet Metal Screw	11
31		Flywheel	1
32		Bearing Housing	2
33		Flywheel Axle	1
34		Woodruff Key	1
35		Flywheel Pulley	1
36		5/16" × UNC18 × 3/4" Button Head Socket Bolt	1
37		Ø8 × Ø20 × 3T Flat Washer	1
38		5/16" × UNC18 × 3/4" Button Head Socket Bolt	6
39		M6 × P1.0 × 10L Flat Phillips Head Screw	8

40	Belt	1
41	Drive Pulley	1
42	Crank Arm (L)	1
43	Crank Arm (R)	1
44	Crank Arm Dust Cap	2
45	Crank Axle	1
46	5/16" × UNC18 × 1/2" _Button Head Socket Bolt	5
48	Ø8 × Ø16 × 1T _Flat Washer	8
49	Ø8 × 1.5T _Split Washer	4
50	Transportation Wheel	2
52	M8 × P1.25 × 10L _Button Head Socket Bolt	2
53	Ø35 × 10m/m Rubber Foot	4
54	3/8" × UNC16 × 7T Nut	4
55	3" Stabilizer End Cap	4
56	End Cap, Eye Tube	2
57	Plastic Slide Insert, Eye Tube	2
58	Bottom End Cap, Eye Tube	2
59	Rear Stabilizer Cover	1
60	Chain Cover (Outer)	1
61	Chain Cover (Inner)	1
63	Pulley Cover	1
64	6004 Bearing (NSK)	2
65	6203 Bearing	2
66	6004 Bearing (TMT)	2
67	Ø17 _C Ring	1
68	Ø20 _C Ring	3
69	1/4" × UNC20 × 3" _Hex Head Bolt	1
70	1/4" × UNC20 × 5.5T Hex Head Bolt	1
71	1/4" × UNC20 × 5.5T _Nyloc Nut	1
72	3/8" × UNC16 × 2" _Flat Head Socket Bolt	2
74	Idler Axle	1
75	Idler Adjustment Carriage Bolt	1
76	Console Assembly	1
78	Ø8 × Ø23 × 2.0T _Flat Washer	1
79	Ø10 × Ø19 × 1.5T _Flat Washer	2

80	M10 × P1.25_Nut	2
81	3/8" × UNC16 × 3-1/2" _Carriage Bolt	4
82	3/8" × UNC16 × 12.5T_Cap Nut	4
83	Ø10 × Ø23 × 1.5T_Curved Washer	4
85	14/15m/m_Wrench	1
86	M5 Combination M5 Allen Wrench & Phillips Head Screw	1
87	Drink Bottle	1
88	5/16" × UNC18 × 5/8" _Button Head Socket Bolt	4
89	M5 × P0.8 × 10L_Socket Head Cap Screw	4
90	Ø5 × 10L_Tapping Screw	4
91	M5 × P0.8 × 10L_Phillips Head Screw	2
92	M5_Speed Nut Clip	1
93	M5 × 10L_Tapping Screw	11
99	3/8" × UNC16 × 3/4" Button Head Socket Bolt	2
100	Ø10 × Ø21 × 2T_Flat Washer	2
107	Braking Magnet	5
117	Magnet Base	1
118	Magnet Separator	1
119	M3 × P0.5 × 6L_Socket Head Cap Bolt	2
120	Ø4 × Ø14 × 1T_Flat Washer	2
121	M4 × P0.7 × 8L_Phillips Head Screw	2
122	Adjustment Cover(L)	1
123	Adjustment Cover(R)	1
124	5/16" × UNC18 × 2" _Hex Head Bolt	1
125	5/16" × UNC18 × 5.8T_Lock Nut	1
126	Powder metallurgy	2
127	5/16" × UNC18 × 1-3/4" _Hex Head Bolt	1
128	5/16" × UNC18 × 6T_Nyloc Nut	3
129	Ø8 × Ø24 × 3T_Nylon Washer	1
130	M6 × P1.0 × 12L_Button Head Socket Bolt	1
131	M6 × P1.0 × 55L_Hex Head Bolt	1
132	M6 × P1.0 × 5.0T_Lock Nut	1